



U.S. 1 at Old Dixie Highway Roundabout

Flagler County

Financial Project ID No.: 441210-1

Project Details

The Florida Department of Transportation (FDOT) is building a new roundabout at the intersection of U.S. 1, Old Dixie Highway and County Road (C.R.) 325 in Flagler County. The project is designed to slow traffic at the intersection and improve safety by eliminating crossing conflicts.

The roundabout will accommodate two travel lanes on northbound U.S. 1 and will include a bypass lane for southbound U.S. 1 traffic traveling through the intersection. Both Old Dixie Highway and C.R. 325 will connect directly to U.S. 1. The project also includes drainage improvements, landscaping in the center of the roundabout and new lighting, as well as signing and pavement markings.

Construction Schedule

The roundabout will be built in four phases to maintain open travel lanes on U.S. 1, though the speed limit will be reduced. At various times during construction, drivers can expect lane shifts, changing traffic patterns and detours on U.S. 1 and Old Dixie Highway. Electronic message boards and other signage will be in place to assist drivers.

Construction is expected to begin in December and take about 15 months to complete. Work may take place during the day or night.

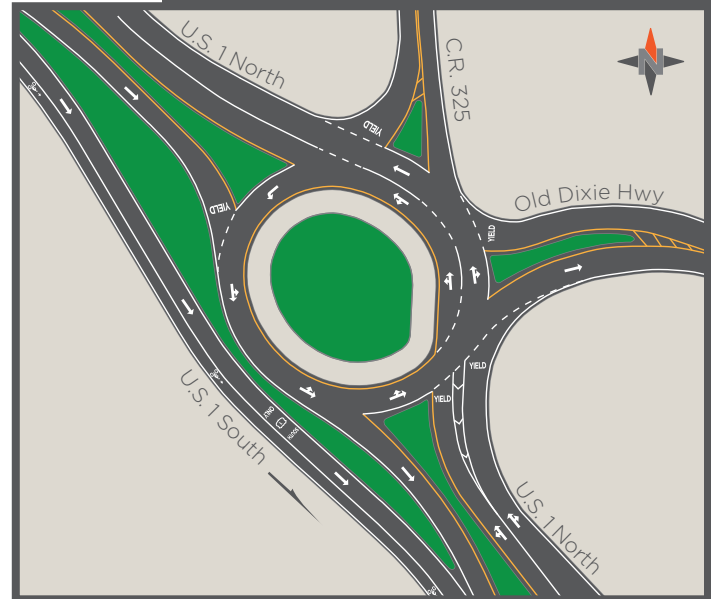

FAST FACTS

Contractor:
P&S Paving, Inc.

Total Cost:
\$4.3 million

Work to Begin:
December 2018

Estimated Completion:
Summer 2020

For more information,
please contact:

Amber Mullins
Community Outreach Coordinator
386-740-3566
or
amber.mullins@dot.state.fl.us

Please use caution when driving through the work zone.

Project Location

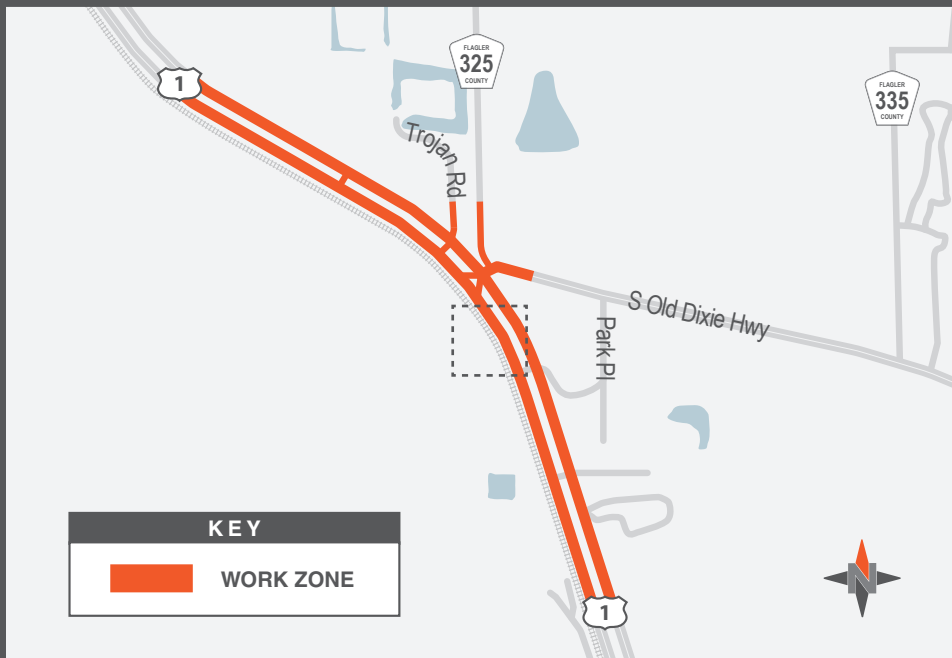

CFLRoads.com



[@MyFDOT_CFL](https://twitter.com/MyFDOT_CFL)



Facebook.com/MyFDOTCFL

Your source for information on state roadway projects in Central Florida is just a "click" away!
Visit www.cflroads.com to view anticipated lane closures and current information about this project.

Updated 5/13/2020

Navigating a Roundabout



Drivers will be warned to slow down to **25 mph** as they approach the roundabout. Pavement markings and signs will direct drivers to use the appropriate lane for their desired destination. Examples include:

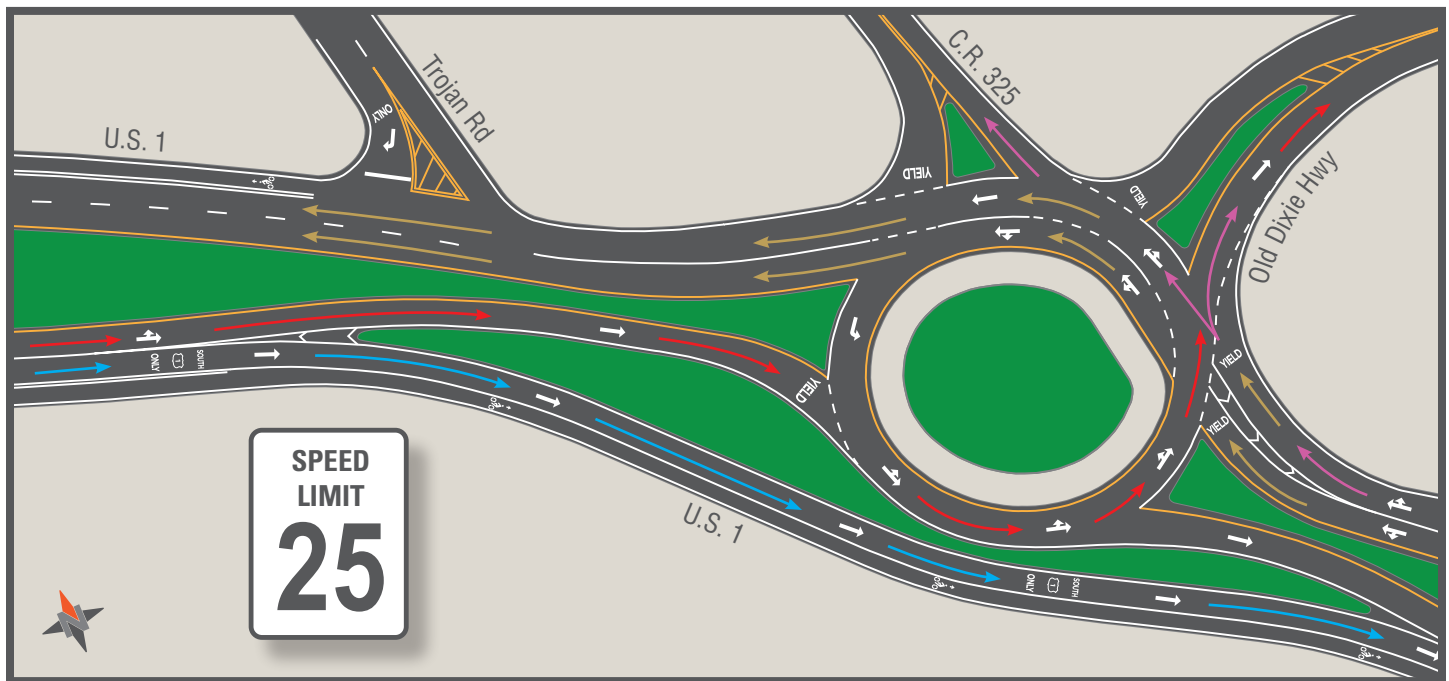

Motorists traveling south on **U.S. 1** who want to turn onto **Old Dixie Highway** will enter the roundabout using the inside lane.

Motorists continuing south on U.S. 1 may use the outside bypass lane.

Motorists traveling north on U.S. 1 will use the outside lane to get onto Old Dixie Highway or C.R. 325.

Motorists continuing north on U.S. 1 can use **either** the inside or outside lane.



Drivers should yield to traffic already in the roundabout and enter when there is an opening.



EMERGENCY VEHICLES:

Vehicles that have not entered the roundabout should pull over to the right and allow the emergency vehicle to pass. Vehicles in the roundabout should continue to the closest exit, then pull over to the right to allow the emergency vehicle to pass.

Do not stop in a roundabout.

BICYCLISTS:

Bicyclists may share the travel way with vehicles in a roundabout, or dismount and use the sidewalk and crosswalk system to navigate through the roundabout.

TRUCKS:

The roundabout accommodates vehicles of all sizes, including passenger cars, buses and large trucks.