



Ridgewood Avenue (U.S. 1/S.R. 5) at Holly Hill City Hall Safety Improvements

Volusia County

Financial Project Identification (FPID) No.: 992500-4



Project Description

The Florida Department of Transportation (FDOT) is proposing two separate but complementary safety improvements along Ridgewood Avenue (U.S. 1/State Road (S.R.) 5) in front of Holly Hill City Hall (MacArthur Circle). The goal is to enhance safety for pedestrians and drivers, improve traffic flow along Ridgewood Avenue and reduce conflict points where crashes are more likely to occur.

Proposed Improvements

- **Median Modification:** Convert the existing full median opening into a two-way directional median opening in front of Holly Hill City Hall (See Figure 1 on reverse). This will:
 - Allow U-turns for both northbound and southbound traffic on Ridgewood Avenue.
 - Permit left turns into City Hall from southbound Ridgewood Avenue.
 - Permit left turns into Pictona at Holly Hill from northbound Ridgewood Avenue.
 - Prohibit left turns out of City Hall (MacArthur Circle).
 - Prohibit left turns out of the Pictona at Holly Hill driveway.
- **New Pedestrian Crossing:** A new midblock crosswalk is proposed in front of City Hall (See Figure 1 on reverse). This crosswalk will feature Rectangular Rapid Flashing Beacons (RRFBs) - pedestrian-activated signals with flashing lights to alert drivers when someone is crossing. These signals include audible alerts for improved accessibility. Curbs and curb ramps will be constructed to meet current Americans with Disabilities Act (ADA) standards.

Please note that while the proposed improvements are being presented together, the median modification and pedestrian crossing projects are not dependent on each other. The development paths of each project will be determined after community input is received and upon further evaluation by FDOT.



Contact Information:

Kevin Marquez, P.E.
FDOT Project Manager
386-943-5527
Kevin.Marquez@dot.state.fl.us
CFLRoads.com

Project Status & Estimated Costs*

*Subject to change

Median Modification		Pedestrian Crossing with RRFB	
<u>DESIGN:</u>		<u>DESIGN:</u>	
Status: Pending	\$ 0 (in-house)	Status: In progress	\$ 82,000
<u>CONSTRUCTION:</u>		<u>CONSTRUCTION:</u>	
Status: Pending	\$ 50,000	Status: 2026	\$ 150,000

Public participation is solicited without regard to race, color, national origin, age, sex, religion, disability, or family status. Persons wishing to express their concerns relative to FDOT compliance with Title VI may do so by contacting Melissa McKinney, FDOT District Five Title VI Coordinator, at Melissa.McKinney@dot.state.fl.us.

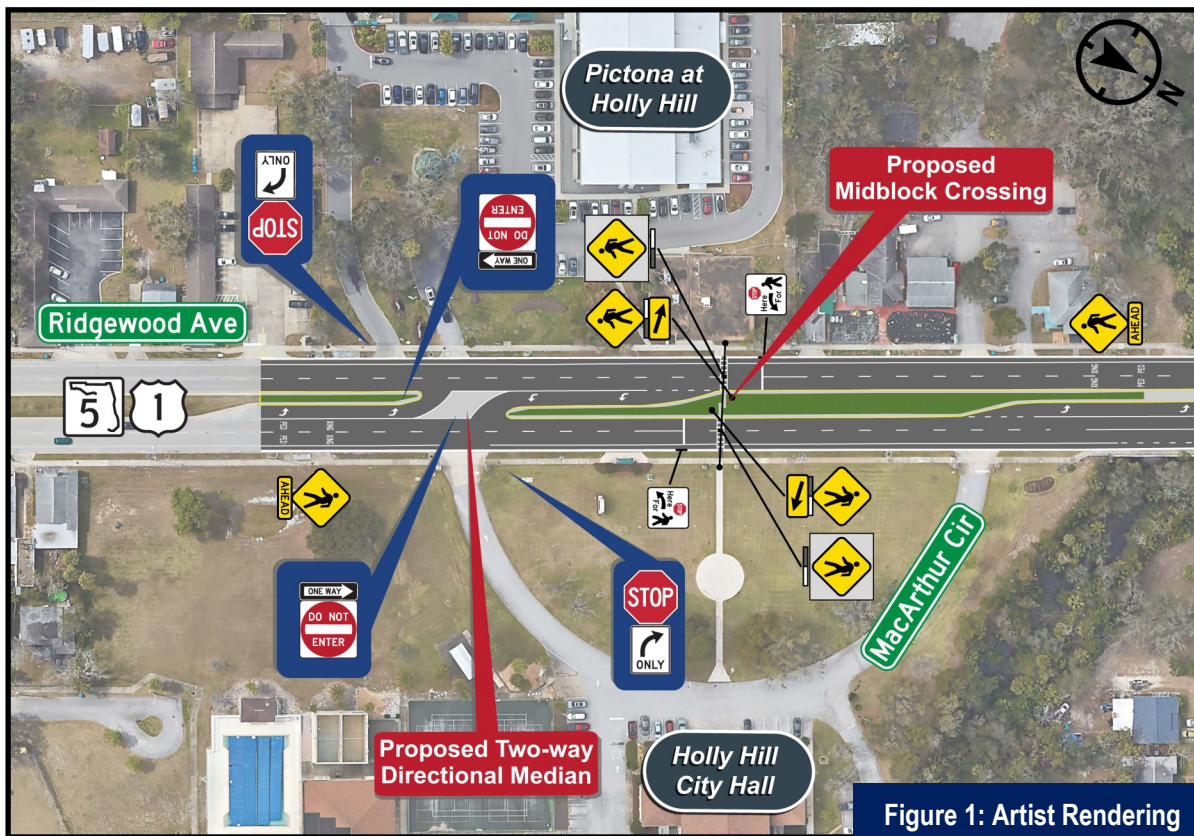

Figure 1: Artist Rendering



HOW TO USE AN RRFB

(Rectangular Rapid Flashing Beacon)

Pedestrians and Bicyclists



Press the button to activate the RRFB signals; the lights will begin to flash indicating to motorists a pedestrian is ready to cross.

Pedestrians

1. Make eye contact with motorists to be sure traffic is yielding before entering the crosswalk.
2. Walk defensively, scanning both directions to be sure motorists see you.
3. Always scan the road while crossing making sure all vehicles have stopped.

Bicyclists

1. Obey all traffic signs and signals.
2. When using the crosswalk, follow the pedestrian rules.
3. When using the travel lane, ride in the direction of traffic and always yield to pedestrians.

www.AlertTodayFlorida.com

Funded by the Florida Department of Transportation

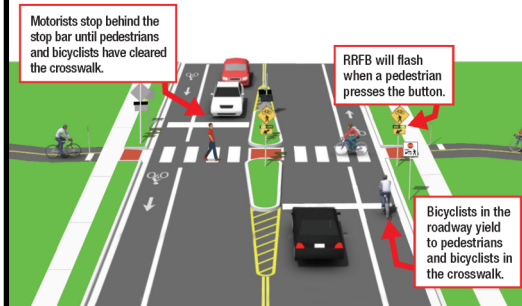

HOW TO USE AN RRFB

(Rectangular Rapid Flashing Beacon)

Motorists

Always stop for pedestrians and bicyclists at crosswalks.

1. Anticipate pedestrians crossing when approaching an RRFB.
2. Never pass another vehicle that has stopped or is slowing down at a crosswalk.
3. Always stop before the stop bar (line) pavement markings.
4. Never stop in or block a crosswalk.
5. Always stop for pedestrians entering or in a crosswalk.
6. Remain stopped for pedestrians regardless of activated RRFBs.
7. Wait for pedestrians to completely clear the crosswalk on your side of the road, and for anyone crossing into your lanes from the other direction.



RRFBs use an irregular flash pattern that is similar to emergency flashers on police vehicles.

(Source: FHWA, 2008)