

CONTRACT PLANS COMPONENTS

ROADWAY
SIGNING AND PAVEMENT MARKING
SIGNALIZATION

INDEX OF SIGNALIZATION PLANS

SHEET NO.	SHEET DESCRIPTION
T-1	KEY SHEET
T-2	GENERAL NOTES
T-3 - T-22	SIGNALIZATION PLAN
T-23	GUIDE SIGN WORKSHEET
T-24 - T-25	STRAIN POLE TABULATION

STATE OF FLORIDA
DEPARTMENT OF TRANSPORTATION

SIGNALIZATION PLANS

FINANCIAL PROJECT ID 443838-1-52-01
SEMINOLE COUNTY (77120)
STATE ROAD NO. 434
FROM OLEANDER STREET TO WEST OF SR 15/600/US 17-92

PROJECT LOCATION URL: <https://tinyurl.com/bde5uae4>
PROJECT LIMITS: BEGIN MP 6.867 - END MP 9.091
EXCEPTIONS: MP 7.622 - MP 8.087
BRIDGE LIMITS: NONE
RAILROAD CROSSING: NONE

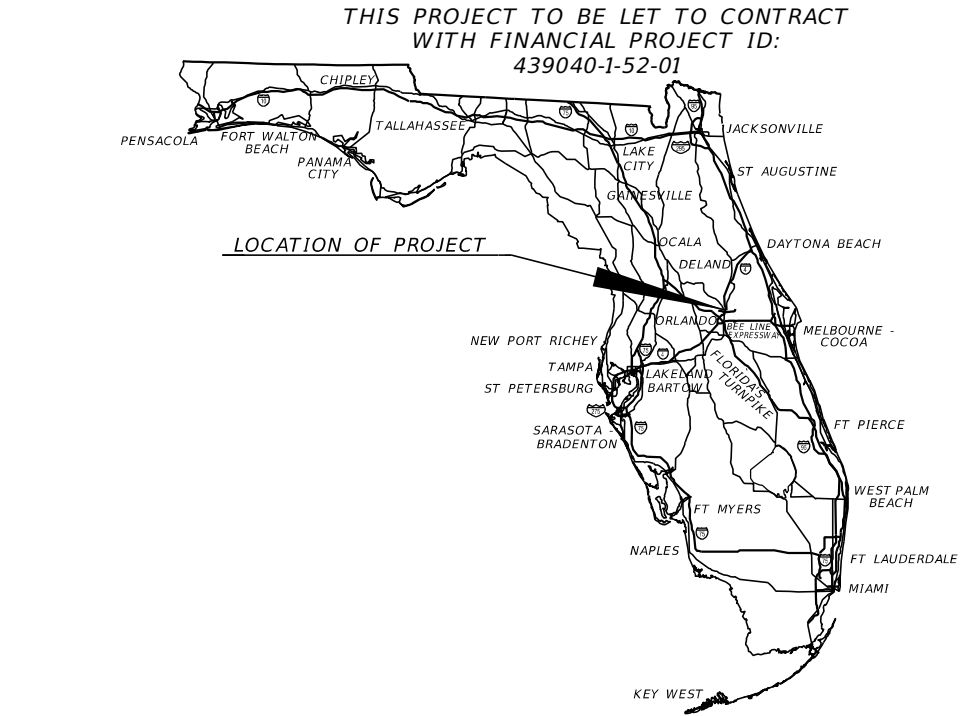

PHASE II SUBMITTAL
APRIL 2025

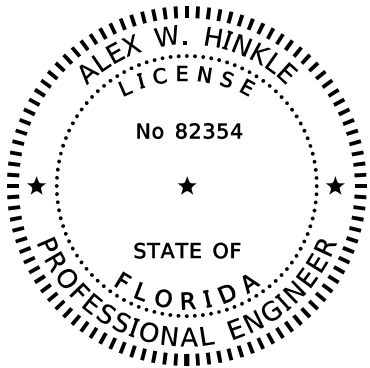

SIGNALIZATION PLANS
ENGINEER OF RECORD:

ALEX W. HINKLE, P.E. NO.: 82354
PROTEAN DESIGN GROUP
100 EAST PINE STREET, SUITE 600
ORLANDO, FL 32801
(407) 246-0044
CONTRACT NO.: CAA68
VENDOR NO.: F59-3473441

FDOT PROJECT MANAGER:

DEREK DEAN, P.E.

GOVERNING STANDARD PLANS:

Florida Department of Transportation, FY2026-27 Standard Plans for Road and Bridge Construction and applicable Interim Revisions (IRs).

Standard Plans for Road Construction and associated IRs are available at the following website: <http://www.fdot.gov/design/standardplans>

GOVERNING STANDARD SPECIFICATIONS:

Florida Department of Transportation, FY 2026-27 Standard Specifications for Road and Bridge Construction at the following website: <http://www.fdot.gov/programmanagement/Implemented/SpecBooks>

CONSTRUCTION CONTRACT NO.	FISCAL YEAR	SHEET NO.
TBD	26	T-1

4/17/2025 5:12:28 PM jparto\ja T:\Worksets\FDOT\4438381\Signalization\GMMT5G01.dgn

GENERAL NOTES:

1. THE MAINTAINING AGENCY FOR THE SIGNALIZATION IS SEMINOLE COUNTY TRAFFIC ENGINEERING AT (407) 665-5588.
2. CONTACT THE MAINTAINING AGENCY AT LEAST 48 HOURS PRIOR TO BEGINNING ANY WORK AT ANY SIGNALIZED INTERSECTION MAINTAINED BY SEMINOLE COUNTY.
3. IF EXISTING ITS FACILITIES ARE IMPACTED BY CONSTRUCTION ACTIVITIES, THE CONTRACTOR SHALL CONTACT THE FDOT TRAFFIC OPERATIONS MANAGER AT (386) 943-5000.
4. AT NO TIME IS THE CONTRACTOR TO CHANGE ANY SIGNAL TIMINGS OR OPERATING PLANS WITHOUT PRIOR CONSENT FROM SEMINOLE COUNTY TRAFFIC ENGINEERING.
5. SHOP DRAWINGS FOR SIGNALIZATION EQUIPMENT AND MATERIALS ARE TO BE SUBMITTED TO BOTH THE ENGINEER OF RECORD AND SEMINOLE COUNTY FOR REVIEW AND COMMENT.
6. UTILIZE EXISTING PULL BOXES AND CONDUIT TO THE EXTENT POSSIBLE.
7. CONTROLLER MODIFICATIONS TO INCLUDE ALL WORK NECESSARY TO ACCOMMODATE THE PROPOSED SIGNAL CONFIGURATION, INCLUDING BUT NOT LIMITED TO: WIRING AND TERMINATION OF PEDESTRIAN SIGNALS AND DETECTORS (VEHICULAR AND PEDESTRIAN), TERMINATION OF SIGNAL CABLE, CONFIGURATION OF THE CONTROLLER FOR SIGNAL TIMINGS AND THE SIGNAL OPERATING PLAN (SOP), WIRING OR RE-WIRING OF PROPOSED AND EXISTING LOOP DETECTOR WIRING, AND INSTALLATION OF LOOP DETECTOR CARDS TO SUPPORT AUTOMATED TRAFFIC SIGNAL PERFORMANCE MEASURES (ATSPM) FUNCTIONALITY.
8. GRIDSMART DETECTION ZONES ARE TO REMAIN UNLESS OTHERWISE NOTED.

LOOPS & SIGNAL CABLE:

1. STOP BAR DETECTION ZONES ARE TO BE ESTABLISHED 5 FEET IN FRONT OF THE STOP BAR. DETECTION LOOPS ARE TO BE CENTERED IN THEIR ASSOCIATED LANES. DIMENSIONS SHOWN ON PLAN SHEETS FOR ADVANCE LOOPS ARE MEASURED FROM THE STOP BAR. DETECTION LOOP DIMENSIONS ARE AS FOLLOWS (UNLESS OTHERWISE NOTED ON THE PLANS:
TYPE B LOOPS: 6' X 6'
TYPE F LOOPS: 6' X 40'
2. USE THE EXISTING INTERMEDIATE PULL BOXES ADJACENT TO THE PROPOSED LOOPS TO SPLICE PROPOSED LOOPS TO EXISTING LOOP CABLING.
3. TEMPORARY RELOCATION OF EXISTING SIGNAL AND LOOP CONDUIT AND CABLE MAY BE REQUIRED TO ACCOMMODATE THE INSTALLATION OF PROPOSED FEATURES.
4. ALL SIGNAL CABLE SHALL HAVE THREE SPARE CONDUCTORS.

SIGNAL HEADS AND PEDESTRIAN DETECTORS:

1. ALL SIGNAL HEADS SHALL BE DIE CAST ALUMINUM OR POLYCARBONATE WITH TUNNEL VISORS.
2. ALL SIGNAL HEADS AND PEDESTRIAN DETECTORS SHALL HAVE WEEP HOLES.
3. SECURE WATERTIGHT SEALS TO SEAL HOLES CREATED BY THE REMOVAL OF EXISTING PEDESTRIAN SIGNAL FEATURES (SIGNAL HEADS, DETECTORS, AND/OR SIGNS) MOUNTED ON MAST ARM/STANDALONE PEDESTRIAN POLES. REFINISH AND PAINT THE SEALS TO MATCH THE FINISH AND COLOR OF THE ADJACENT EXISTING POLE SURFACE. SUBMIT THE SEAL, REFINISHING MATERIALS, AND PROCEDURE FOR APPROVAL BY THE ENGINEER.

LEGEND:

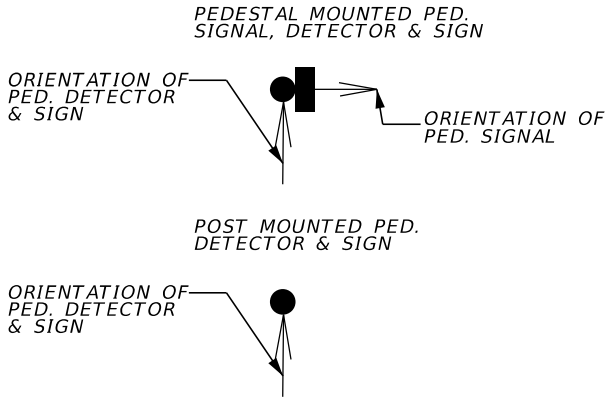

- CR CONDUIT RUN
H.V.S. HIGH VOLTAGE - SIGNAL
L.V.D. LOW VOLTAGE - DETECTOR
- CR1: 2 RUNS W/
(1) 2" CONDUIT - H.V.S.
(1) 2" CONDUIT - L.V.D.
- CR2: 4 RUNS W/
(1) 2" CONDUIT - H.V.S.
(1) 2" CONDUIT - L.V.D.
(1) 2" CONDUIT - SPARE
- CR3: 2 RUNS W/
(1) 2" CONDUIT - L.V.D.
(1) 2" CONDUIT - SPARE

PAY ITEM NOTES:

646-1-11/12:
SHALL INCLUDE ALL COSTS ASSOCIATED WITH THE REMOVAL AND REPLACEMENT OF EXISTING SIDEWALK AND/OR SIDEWALK CURB REQUIRED FOR THE INSTALLATION OF THE POLE, BASE, AND FOUNDATION. THIS INCLUDES, BUT IS NOT LIMITED TO, SAW CUTTING, DEMOLITION, DISPOSAL, FORMING, POURING, FINISHING, AND CURING OF ALL AFFECTED CONCRETE SURFACES.

653-1-60/665-1-60/700-3-601:
SHALL INCLUDE THE COST OF SECURING A WATERTIGHT SEAL ON EXISTING OPEN CABLE ENTRY AND EQUIPMENT MOUNTING HOLES RESULTING FROM ITEM REMOVALS, AND THE REFINISHING/PAINTING OF THE SEAL.

660-2-102 & 660-2-106:
SHALL INCLUDE THE REPLACEMENT OF ALL EXISTING LOOP LEAD-IN CABLE BETWEEN THE LOOP DETECTOR IN THE SIGNAL CABINET AND THE PULL BOX ADJACENT TO THE IN PAVEMENT TWISTED PAIR. SPLICE PROPOSED LOOP LEAD-IN CABLE TO EXISTING TWISTED PAIR CABLE IN PULL BOX.

700-5-22:
INTERNALLY ILLUMINATED STREET NAME SIGNS ARE TO BE DOUBLE-SIDED, FREE SWINGING, AND MOUNTED TO A SEPARATE CANTILEVER ARM ATTACHED TO THE EXISTING STRAIN POLE SUCH THAT A MINIMUM VERTICAL CLEARANCE OF 17.5 FT IS MAINTAINED FROM THE BOTTOM OF THE SIGN TO THE GRADE DIRECTLY BELOW THE SIGN.

NOTES TO REVIEWERS:

1. THE SCOPE INCLUDES THE REPLACEMENT OF THE EXISTING 5-SECTION CLUSTER SIGNAL HEADS WITH A 4-SECTION FLASHING YELLOW ARROW (FYA) LEFT TURN SIGNAL HEAD AND AN ADDITIONAL 3-SECTION BALL SIGNAL HEAD FOR THE MAINLINE LEFT TURN / THROUGH MOVEMENTS AT THE INTERSECTIONS OF SR 434 / GRANT ST AND SR 434 / WAYMAN ST. THE SCOPE ALSO INCLUDES A TIME OF DAY ANALYSIS FOR THE FYA OPERATION HOWEVER THE TRAFFIC DATA NECESSARY TO PERFORM THIS DATA IS NOT YET AVAILABLE. THE TIME OF DAY ANALYSIS AND NECESSARY PLAN NOTES WILL BE INCLUDED WITH THE NEXT SUBMITTAL.

2. IN ADDITION TO THE FYA SIGNAL HEAD SCOPE MENTIONED IN NOTE #1, THE SCOPE ALSO INCLUDES THE ADDITION OF FLEXIBLE, RETRO-REFLECTIVE BACKPLATES AT THE INTERSECTIONS SR 434 / GRANT ST AND SR 434 / WAYMAN ST. AFTER REVIEW OF THE VERTICAL CLEARANCE TO THE EXISTING SIGNAL HEADS, IT WAS DETERMINED THAT THE CHANGE TO A FYA SIGNAL HEAD AND/OR THE ADDITION OF BACKPLATES WILL REDUCE THE MINIMUM VERTICAL CLEARANCE TO BE LESS THAN THE FDMS DESIRED 17'-6". COORDINATION WITH THE DEPARTMENT FOR RESOLUTION OF THIS ITEM IS ON-GOING.

LEGEND:

SYMBOL	DESCRIPTION	SYMBOL	DESCRIPTION
	Exist. Ground Mounted Signal Cabinet		PROPOSED TYPE B LOOP
	Exist. Signal Pull Box		PROPOSED TYPE F LOOP
	Exist. Traffic Signal (3-Section OR 4-Section)		PROPOSED PULL BOX 13" X 24"
	Exist. Traffic Signal (5-Section Cluster)		PROPOSED TRAFFIC SIGNAL (3-SECTION OR 4-SECTION)
	Exist. CCTV Camera		CONDUIT (OPEN TRENCH)
	Exist. GPS Preemption Device		CONDUIT (DIRECTIONAL BORE)
	Exist. IMC Camera		
	Exist. Connected Vehicle Roadside Unit		
	Exist. Bluetooth Device		
	Exist. Vehicle Detection Camera		
	Exist. Optical Preemption Device		
	Exist. Ped Features		
	Exist. Type B Loop		
	Exist. Type F Loop		

REVISIONS				ENGINEER OF RECORD			STATE OF FLORIDA DEPARTMENT OF TRANSPORTATION			GENERAL NOTES	SHEET NO.
DATE	DESCRIPTION		DATE	DESCRIPTION			ROAD NO.	COUNTY	FINANCIAL PROJECT ID		
						ALEX W. HINKLE, P.E. LICENSE NUMBER: 82354 PROTEAN DESIGN GROUP 100 EAST PINE STREET, SUITE 600 ORLANDO, FL 32801	SR 434	SEMINOLE	443838-1-52-01		T-2

THE OFFICIAL RECORD OF THIS SHEET IS THE ELECTRONIC FILE DIGITALLY SIGNED AND SEALED UNDER RULE 61G15-23.004, F.A.C.

NOTES:

1. UTILIZE EXISTING CONDUIT & PULL BOX TO ROUTE PROPOSED CABLING TO EXISTING SIGNAL CABINET.
2. THE ADVANCE LOOPS/SPLICE BOXES ARE NOT POSITIONED AS INDICATED BY THE BASELINE OR SURVEY BUT ARE PLACED AT THE SHOWN DISTANCE.

REMOVAL ITEM:

632-7-6 1 PI

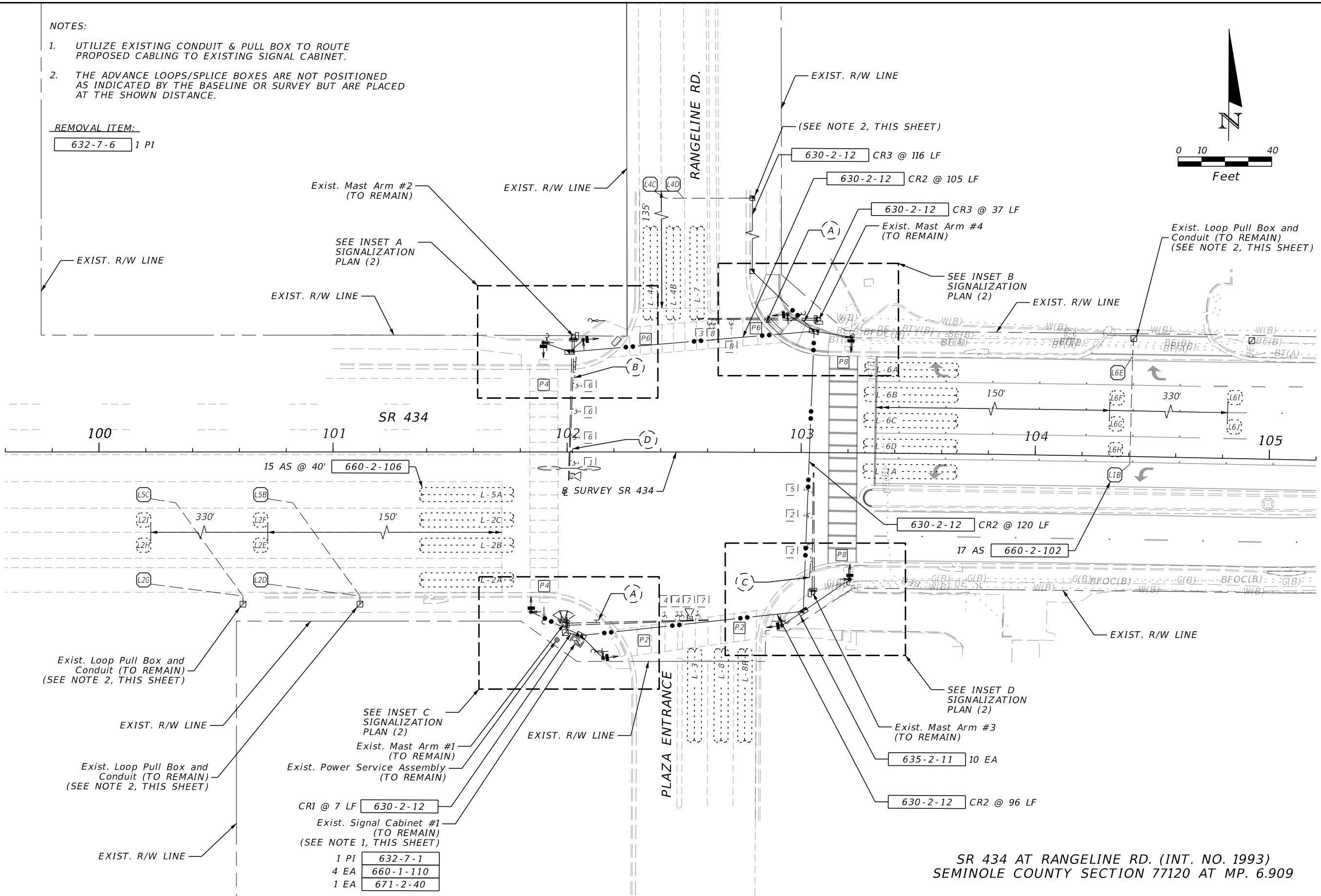
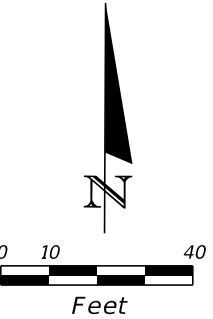

SR 434 AT RANGELINE RD. (INT. NO. 1993)
SEMINOLE COUNTY SECTION 77120 AT MP. 6.909

4/17/2025 5:26:34 PM jparto\ja T:\Worksets\FDOT\4438381\Signalization\PLANS\G01.dgn

REVISIONS				ENGINEER OF RECORD	STATE OF FLORIDA DEPARTMENT OF TRANSPORTATION			SHEET NO.
DATE	DESCRIPTION	DATE	DESCRIPTION		ROAD NO.	COUNTY	FINANCIAL PROJECT ID	
					SR 434	SEMINOLE	443838-1-52-01	

ALEX W. HINKLE, P.E.
LICENSE NUMBER: 82354
PROTEAN DESIGN GROUP
100 EAST PINE STREET, SUITE 600
ORLANDO, FL 32801

SIGNALIZATION PLAN (1)

T-3

THE OFFICIAL RECORD OF THIS SHEET IS THE ELECTRONIC FILE DIGITALLY SIGNED AND SEALED UNDER RULE 61G15-23.004, F.A.C.

4/17/2025 5:13:27 PM jparto\ja T:\Worksets\FDOT\4438381\Signalization\PLAN5G02.dgn

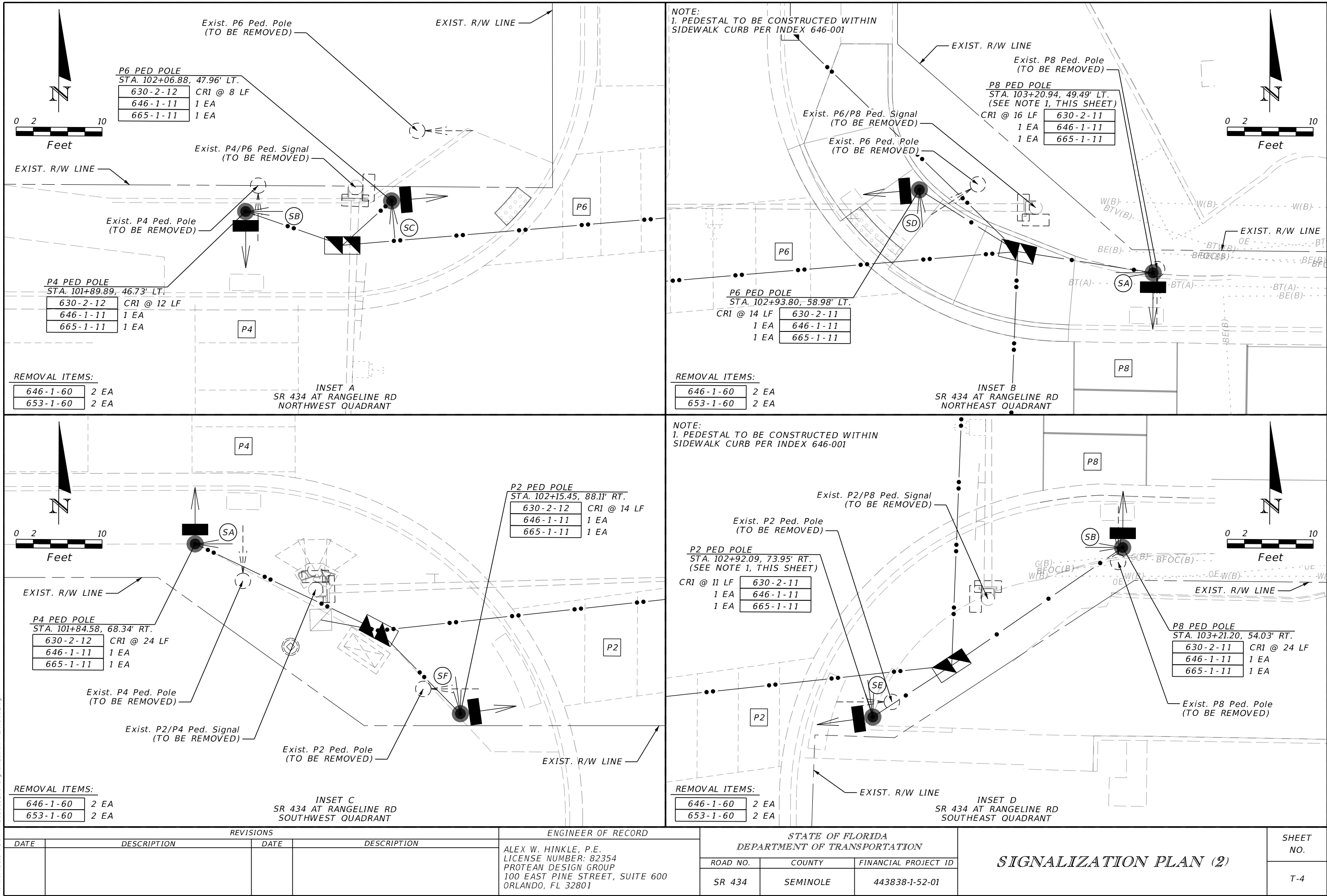

THE OFFICIAL RECORD OF THIS SHEET IS THE ELECTRONIC FILE DIGITALLY SIGNED AND SEALED UNDER RULE 61G15-23.004, F.A.C.

NOTES:

- THE MAJOR STREET IS SR 434, MOVEMENTS 2 AND 6.
THE MINOR STREET IS RANGELINE RD. AND PLAZA ENTRANCE, MOVEMENTS 4 AND 8.
- STANDARD SIGNAL OPERATING PLAN 9 IS TO REMAIN AS SHOWN BELOW.
- POSTED SPEEDS:
 - SR 434: 45 MPH
 - RANGELINE RD: 35 MPH
 - PLAZA ENTRANCE: 9 MPH

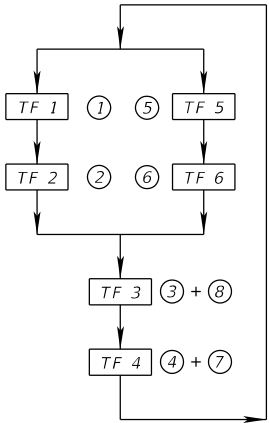
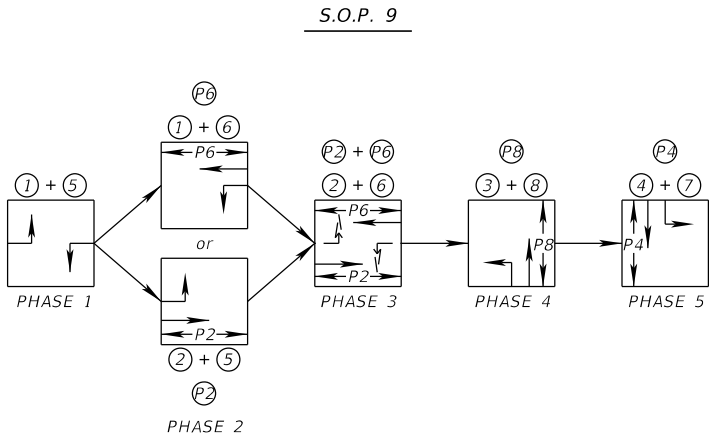

TABLE 1: CONTROLLER TIMINGS

MOVEMENT NUMBER	1	2	4	5	6	8
DIRECTION	WBL	EB	SB	EBL	WB	NB
MINIMUM GREEN*	6	15	6	6	15	6
PASSAGE*	3.0	4.0	3.0	4.0	4.0	3.0
YELLOW	4.8	4.8	4.2	4.8	4.8	3.4
ALL RED	3.4	2.0	3.3	3.6	2.0	3.6
MAX I*	20	120	35	70	120	25
WALK		7.0	8.0		8.0	7.0
FLASH DON'T WALK		18.0	29.0		19.0	27.0
RECALL*		MIN			MIN	

*DENOTES EXISTING VALUE TO REMAIN

EXISTING STREET NAME SIGNS



EXISTING SIGN
(TO REMAIN)

EXISTING SIGN
(TO REMAIN)

EXISTING SIGN
(TO REMAIN)

TRAFFIC SIGNAL HEAD DETAILS

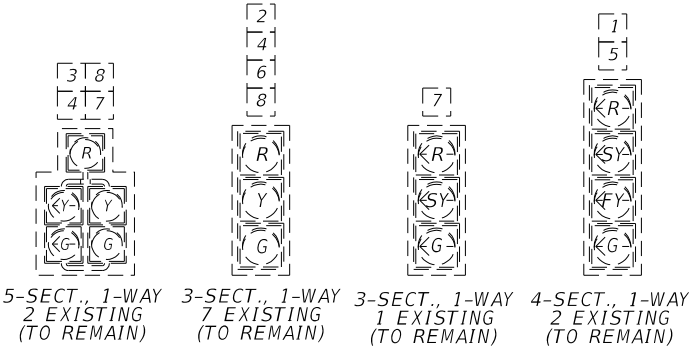

EXISTING OVERHEAD SIGNS



EXISTING SIGN
(TO REMAIN)

PEDESTRIAN SIGNAL HEADS AND SIGN DETAILS

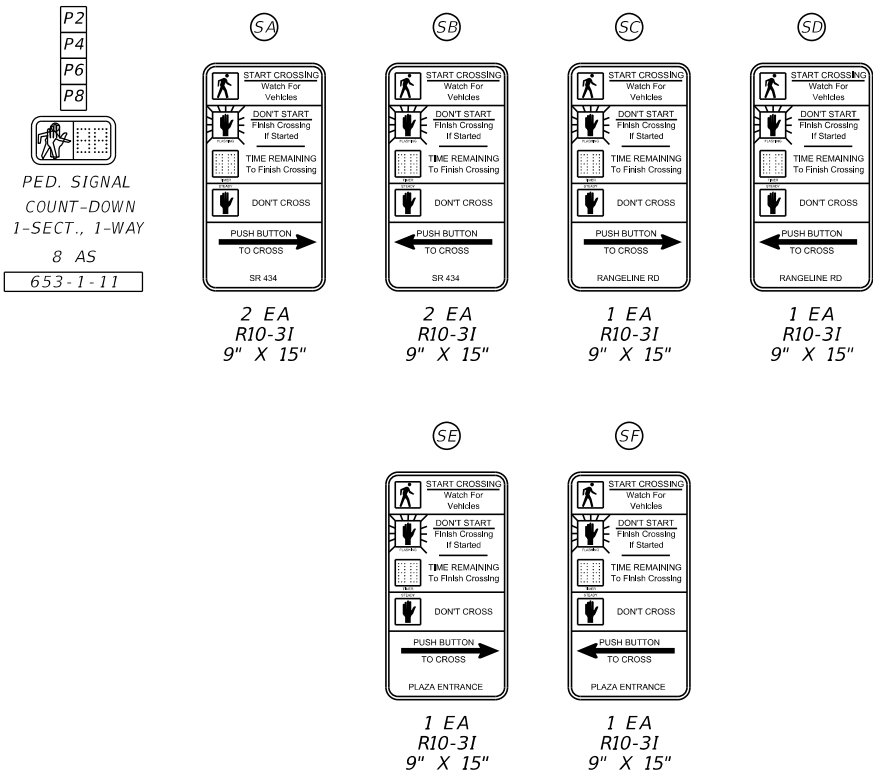

SR 434 AT RANGELINE RD. (INT. NO. 1993)
SEMINOLE COUNTY SECTION 77120 AT MP. 6.909

REVISIONS				ENGINEER OF RECORD		STATE OF FLORIDA DEPARTMENT OF TRANSPORTATION		SIGNALIZATION PLAN (3)	SHEET NO.
DATE	DESCRIPTION	DATE	DESCRIPTION	ALEX W. HINKLE, P.E. LICENSE NUMBER: 82354 PROTEAN DESIGN GROUP 100 EAST PINE STREET, SUITE 600 ORLANDO, FL 32801		ROAD NO.	COUNTY		
						SR 434	SEMINOLE	443838-1-52-01	

4/17/2025 5:13:39 PM jparto\ja T:\Worksets\FDOT\443838\15201\Signalization\PLANS\G03.dgn

SIGNAL ID	BIU NO.	CARD NO.	CHANNEL NO.	DETECTOR ID	DETECTOR	DIRECTION	MOVEMENT TYPE	APP. SPEED (MPH)	PROTECTED PHASE	PERMISSIVE PHASE	OVERLAP	DELAY (SEC)	DETECTOR SYSTEM	ZONE SIZE	DISTANCE TO STOP BAR (FT)	DETECTOR TYPE	LANE TYPE
1993	1	C1	CH1	199301	L - 1A	WB	L	45	1			-	LOOP	6' X 40'	0	PRESENCE	VEHICLE
			CH2	199302	L - 1B	WB	L	45	1			-	LOOP	6' X 6'	150	ADVANCE	VEHICLE
		C2	CH3	199303	L - 2A	EB	R	45	2	5		5	LOOP	6' X 40'	0	PRESENCE	VEHICLE
			CH4	199304	L - 2B	EB	T	45	2	5		-	LOOP	6' X 40'	0	PRESENCE	VEHICLE
		C3	CH5	199305	L - 2C	EB	T	45	2	5		-	LOOP	6' X 40'	0	PRESENCE	VEHICLE
			CH6	199306	L - 2D	EB	R	45	2	5		-	LOOP	6' X 6'	150	ADVANCE	VEHICLE
		C4	CH7	199307	L - 2E	EB	T	45	2	5		-	LOOP	6' X 6'	150	ADVANCE	VEHICLE
			CH8	199308	L - 2F	EB	T	45	2	5		-	LOOP	6' X 6'	150	ADVANCE	VEHICLE
		C5	CH9	199309	L - 2G	EB	R	45	2	5		-	LOOP	6' X 6'	330	QUEUE	VEHICLE
			CH10	199310	L - 2H	EB	T	45	2	5		-	LOOP	6' X 6'	330	QUEUE	VEHICLE
		C6	CH11	199311	L - 2I	EB	T	45	2	5		-	LOOP	6' X 6'	330	QUEUE	VEHICLE
			CH12	199312	L - 3	NB	L	9	3			-	LOOP	6' X 40'	0	PRESENCE	VEHICLE
		C7	CH13	199313	L - 4A	SB	R	35	4	7		5	LOOP	6' X 40'	0	PRESENCE	VEHICLE
			CH14	199314	L - 4B	SB	T	35	4	7		-	LOOP	6' X 40'	0	PRESENCE	VEHICLE
		C8	CH15	199315	L - 4C	SB	R	35	4			-	LOOP	6' X 6'	150	ADVANCE	VEHICLE
			CH16	199316	L - 4D	SB	T	35	4			-	LOOP	6' X 6'	150	ADVANCE	VEHICLE
	2	C1	CH17	199317	L - 5A	EB	L	45	5			-	LOOP	6' X 40'	0	PRESENCE	VEHICLE
			CH18	199318	L - 5B	EB	L	45	5			-	LOOP	6' X 6'	150	ADVANCE	VEHICLE
		C2	CH19	199319	L - 5C	EB	L	45	5			-	LOOP	6' X 6'	330	QUEUE	VEHICLE
			CH20	199320	L - 6A	WB	R	45	6	1		5	LOOP	6' X 40'	0	PRESENCE	VEHICLE
		C3	CH21	199321	L - 6B	WB	T	45	6	1		-	LOOP	6' X 40'	0	PRESENCE	VEHICLE
			CH22	199322	L - 6C	WB	T	45	6	1		-	LOOP	6' X 40'	0	PRESENCE	VEHICLE
		C4	CH23	199323	L - 6D	WB	T	45	6	1		-	LOOP	6' X 40'	0	PRESENCE	VEHICLE
			CH24	199324	L - 6E	WB	R	45	6	1		-	LOOP	6' X 6'	150	ADVANCE	VEHICLE
		C5	CH25	199325	L - 6F	WB	T	45	6	1		-	LOOP	6' X 6'	150	ADVANCE	VEHICLE
			CH26	199326	L - 6G	WB	T	45	6	1		-	LOOP	6' X 6'	150	ADVANCE	VEHICLE
		C6	CH27	199327	L - 6H	WB	T	45	6	1		-	LOOP	6' X 6'	150	ADVANCE	VEHICLE
			CH28	199328	L - 6I	WB	T	45	6	1		-	LOOP	6' X 6'	330	QUEUE	VEHICLE
		C7	CH29	199329	L - 6J	WB	T	45	6	1		-	LOOP	6' X 6'	330	QUEUE	VEHICLE
			CH30	199330	L - 7	SB	L	35	7			-	LOOP	6' X 40'	0	PRESENCE	VEHICLE
		C8	CH31	199331	L - 8	NB	T	9	8	3		-	LOOP	6' X 40'	0	PRESENCE	VEHICLE
			CH32	199332	L - 8R	NB	R	9	8	3		5	LOOP	6' X 40'	0	PRESENCE	VEHICLE
	3	C1	CH33	199333	SPARE												
			CH34	199334	SPARE												
		C2	CH35	199335	SPARE												
			CH36	199336	SPARE												
		C3	CH37	199337	SPARE												
			CH38	199338	SPARE												
		C4	CH39	199339	SPARE												
			CH40	199340	SPARE												
		C5	CH41	199341	SPARE												
			CH42	199342	SPARE												
		C6	CH43	199343	SPARE												
			CH44	199344	SPARE												
		C7	CH45	199345	SPARE												
			CH46	199346	SPARE												
		C8	CH47	199347	SPARE												
			CH48	199348	SPARE												

ANY CHANNELS NOT SHOWN WILL BE SPARES.

SR 434 AT RANGELINE RD. (INT. NO. 1993)
SEMINOLE COUNTY SECTION 77120 AT MP. 6.909

REVISIONS				ENGINEER OF RECORD	STATE OF FLORIDA DEPARTMENT OF TRANSPORTATION			SIGNALIZATION PLAN (4)	
DATE	DESCRIPTION		DATE	DESCRIPTION		ROAD NO.	COUNTY		FINANCIAL PROJECT ID
				ALEX W. HINKLE, P.E. LICENSE NUMBER: 82354 PROTEAN DESIGN GROUP 100 EAST PINE STREET, SUITE 600 ORLANDO, FL 32801		SR 434	SEMINOLE		443838-1-52-01

T-6

THE OFFICIAL RECORD OF THIS SHEET IS THE ELECTRONIC FILE DIGITALLY SIGNED AND SEALED UNDER RULE 61G15-23.004, F.A.C.

NOTES:

1. UTILIZE EXISTING CONDUIT & PULL BOX TO ROUTE PROPOSED CABLING TO EXISTING SIGNAL CABINET.
2. THE ADVANCE LOOPS/SPLICE BOXES ARE NOT POSITIONED AS INDICATED BY THE BASELINE OR SURVEY BUT ARE PLACED AT THE SHOWN DISTANCE.

REMOVAL ITEM:

632-7-6 1 PI

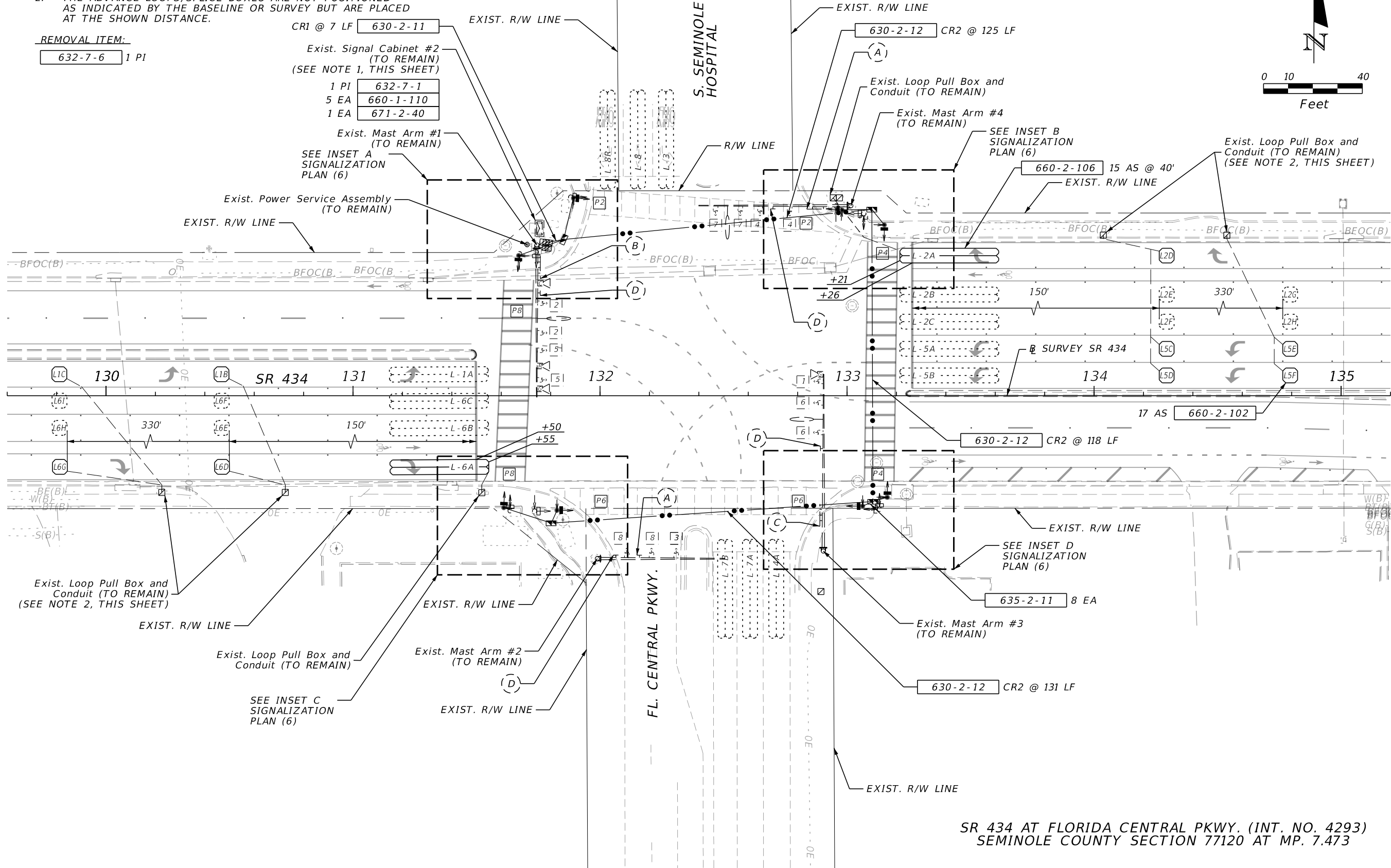

SR 434 AT FLORIDA CENTRAL PKWY. (INT. NO. 4293)
SEMINOLE COUNTY SECTION 77120 AT MP. 7.473

REVISIONS				ENGINEER OF RECORD	STATE OF FLORIDA DEPARTMENT OF TRANSPORTATION			SHEET NO.
DATE	DESCRIPTION	DATE	DESCRIPTION		ROAD NO.	COUNTY	FINANCIAL PROJECT ID	
				ALEX W. HINKLE, P.E. LICENSE NUMBER: 82354 PROTEAN DESIGN GROUP 100 EAST PINE STREET, SUITE 600 ORLANDO, FL 32801	SR 434	SEMINOLE	443838-1-52-01	T-7

4/17/2025 5:14:28 PM jparto\ja T:\Worksets\FDOT\4438381\5201\Signalization\PLAN5G02.dgn

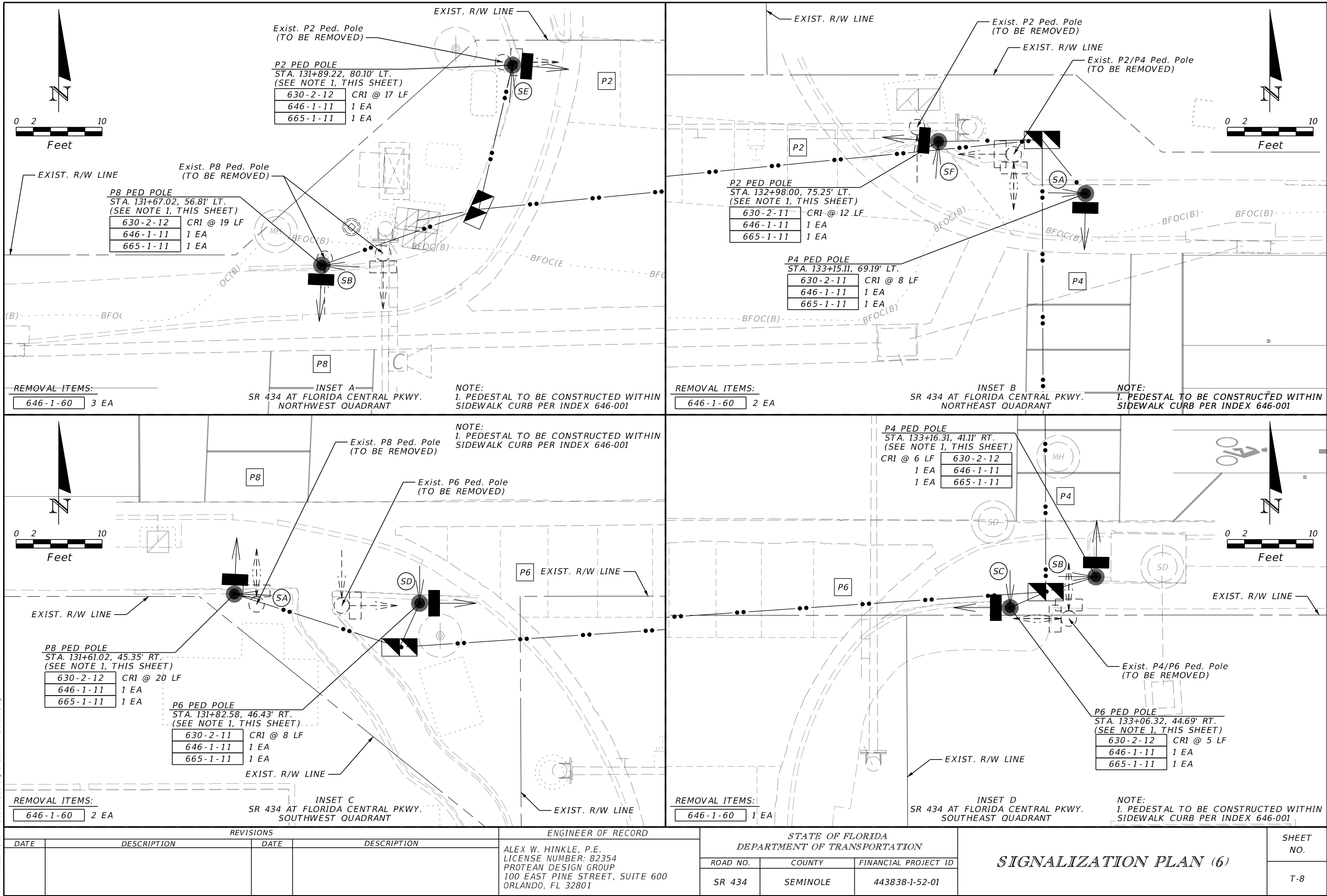

THE OFFICIAL RECORD OF THIS SHEET IS THE ELECTRONIC FILE DIGITALLY SIGNED AND SEALED UNDER RULE 61G15-23.004, F.A.C.

NOTES:

- THE MAJOR STREET IS SR 434, MOVEMENTS 2 AND 6.
THE MINOR STREET IS FLORIDA CENTRAL PKWY. AND SOUTH SEMINOLE HOSPITAL, MOVEMENTS 4 AND 8.
- STANDARD SIGNAL OPERATING PLAN 9 IS TO REMAIN AS SHOWN BELOW.
- POSTED SPEEDS:
 - SR 434: 45 MPH
 - FLORIDA CENTRAL PKWY: 35 MPH
 - SOUTH SEMINOLE HOSPITAL: 9 MPH

S.O.P. 9

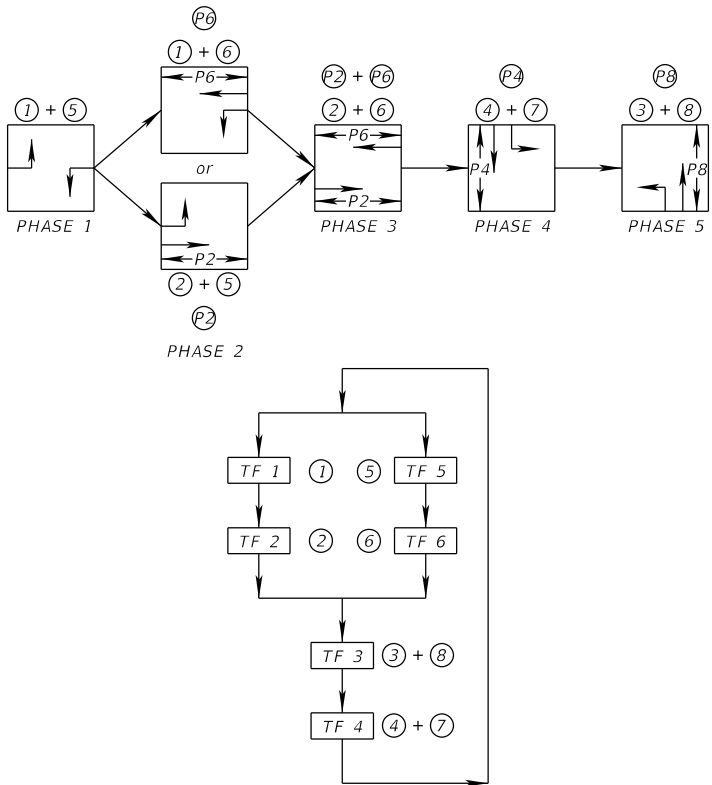
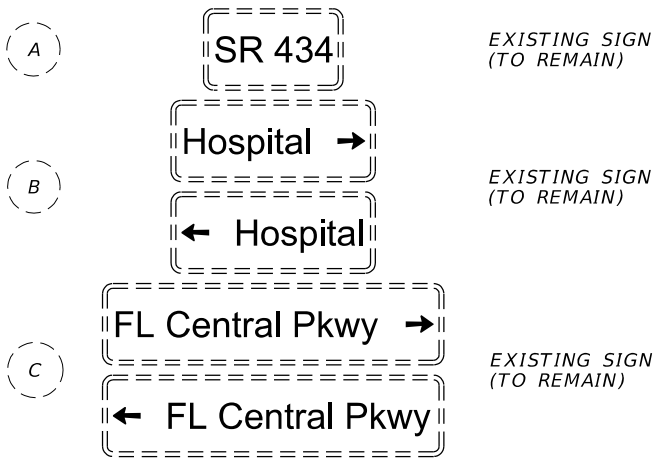

TABLE 1: CONTROLLER TIMINGS

MOVEMENT NUMBER	1	2	4	5	6	7	8
DIRECTION	EBL	WB	NB	WBL	EB	NBL	SB
MINIMUM GREEN*	6	15	6	6	15		6
PASSAGE*	3.0	4.0	4.0	3.0	4.0		4.0
YELLOW	4.8	4.8	4.3	4.8	4.8		3.4
ALL RED	3.6	2.0	3.8	3.7	2.0	3.8	3.3
MAX I*	30	120	45	30	120		30
WALK		7.0	7.0		9.0		7.0
FLASH DON'T WALK		28.0	29.0		32.0		26.0
RECALL*		MIN			MIN		

*DENOTES EXISTING VALUE TO REMAIN

EXISTING STREET NAME SIGNS



TRAFFIC SIGNAL HEAD DETAILS

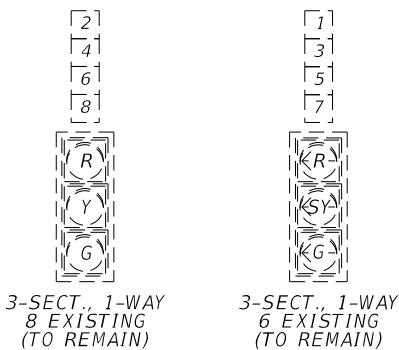

EXISTING OVERHEAD SIGNS

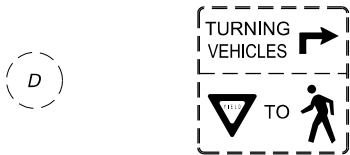

PEDESTRIAN SIGNAL HEADS AND SIGN DETAILS

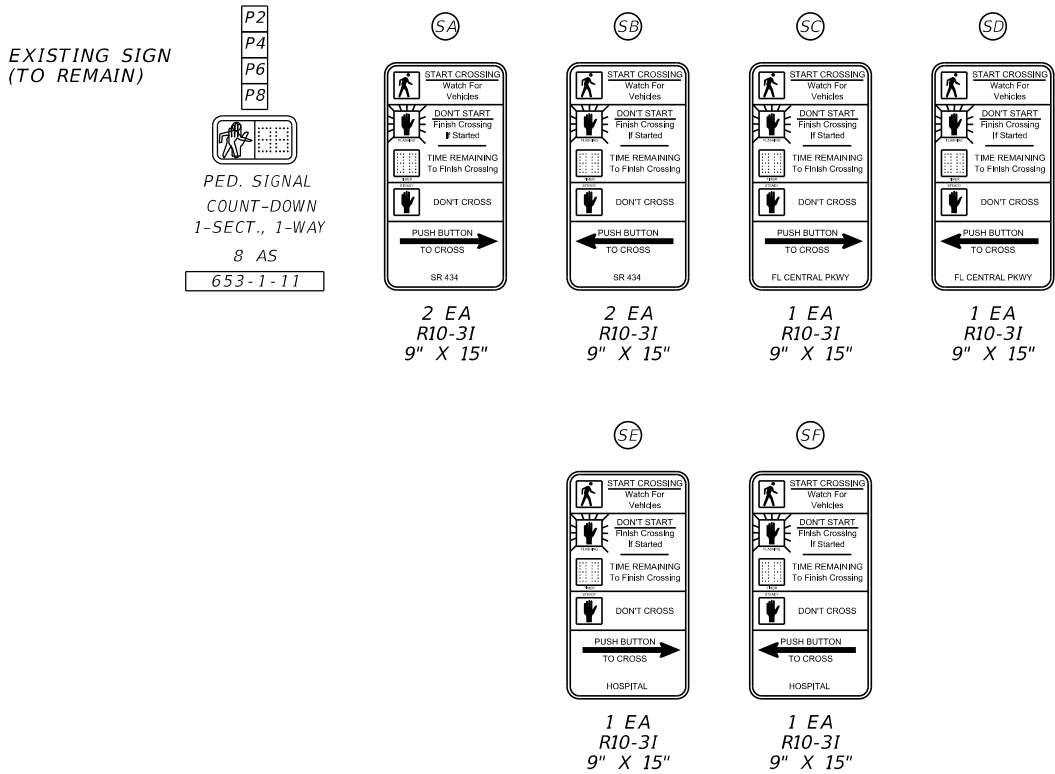

SR 434 AT FLORIDA CENTRAL PKWY. (INT. NO. 4293)
SEMINOLE COUNTY SECTION 77120 AT MP. 7.473

REVISIONS				ENGINEER OF RECORD		STATE OF FLORIDA DEPARTMENT OF TRANSPORTATION		SIGNALIZATION PLAN (7)	SHEET NO.
DATE	DESCRIPTION	DATE	DESCRIPTION	ALEX W. HINKLE, P.E. LICENSE NUMBER: 82354 PROTEAN DESIGN GROUP 100 EAST PINE STREET, SUITE 600 ORLANDO, FL 32801		ROAD NO.	COUNTY		
						SR 434	SEMINOLE	443838-1-52-01	T-9

4/17/2025 5:14:40 PM jparto\ja T:\Worksets\FDOT\4438381\5201\Signalization\PLANS\G03.dgn

SIGNAL ID	BIU NO.	CARD NO.	CHANNEL NO.	DETECTOR ID	DETECTOR	DIRECTION	MOVEMENT TYPE	APP. SPEED (MPH)	PROTECTED PHASE	PERMISSIVE PHASE	OVERLAP	DELAY (SEC)	DETECTOR SYSTEM	ZONE SIZE	DISTANCE TO STOP BAR (FT)	DETECTOR TYPE	LANE TYPE
4293	1	C1	CH1	429301	L - 1A	EB	L	45	1			-	LOOP	6' X 40'	0	PRESENCE	VEHICLE
			CH2	429302	L - 1B	EB	L	45	1			-	LOOP	6' X 6'	150	ADVANCE	VEHICLE
		C2	CH3	429303	L - 1C	EB	L	45	1			-	LOOP	6' X 6'	330	QUEUE	VEHICLE
			CH4	429304	L - 2A	WB	R	45	2			5	LOOP	6' X 40'	0	PRESENCE	VEHICLE
		C3	CH5	429305	L - 2B	WB	T	45	2			-	LOOP	6' X 40'	0	PRESENCE	VEHICLE
			CH6	429306	L - 2C	WB	T	45	2			-	LOOP	6' X 40'	0	PRESENCE	VEHICLE
		C4	CH7	429307	L - 2D	WB	R	45	2			-	LOOP	6' X 6'	150	ADVANCE	VEHICLE
			CH8	429308	L - 2E	WB	T	45	2			-	LOOP	6' X 6'	150	ADVANCE	VEHICLE
		C5	CH9	429309	L - 2F	WB	T	45	2			-	LOOP	6' X 6'	150	ADVANCE	VEHICLE
			CH10	429310	L - 2G	WB	T	45	2			-	LOOP	6' X 6'	330	QUEUE	VEHICLE
		C6	CH11	429311	L - 2H	WB	T	45	2			-	LOOP	6' X 6'	330	QUEUE	VEHICLE
			CH12	429312	L - 3	SB	L	9	3			-	LOOP	6' X 40'	0	PRESENCE	VEHICLE
		C7	CH13	429313	L - 4A	NB	RT	35	4			5	LOOP	6' X 40'	0	PRESENCE	VEHICLE
			CH14	429314	L - 5A	WB	L	45	5			-	LOOP	6' X 40'	0	PRESENCE	VEHICLE
		C8	CH15	429315	L - 5B	WB	L	45	5			-	LOOP	6' X 40'	0	PRESENCE	VEHICLE
			CH16	429316	L - 5C	WB	L	45	5			-	LOOP	6' X 6'	150	ADVANCE	VEHICLE
	2	C1	CH17	429317	L - 5D	WB	L	45	5			-	LOOP	6' X 6'	150	ADVANCE	VEHICLE
			CH18	429318	L - 5E	WB	L	45	5			-	LOOP	6' X 6'	330	QUEUE	VEHICLE
		C2	CH19	429319	L - 5F	WB	L	45	5			-	LOOP	6' X 6'	330	QUEUE	VEHICLE
			CH20	429320	L - 6A	EB	R	45	6			5	LOOP	6' X 40'	0	PRESENCE	VEHICLE
		C3	CH21	429321	L - 6B	EB	T	45	6			-	LOOP	6' X 40'	0	PRESENCE	VEHICLE
			CH22	429322	L - 6C	EB	T	45	6			-	LOOP	6' X 40'	0	PRESENCE	VEHICLE
		C4	CH23	429323	L - 6D	EB	R	45	6			-	LOOP	6' X 6'	150	ADVANCE	VEHICLE
			CH24	429324	L - 6E	EB	T	45	6			-	LOOP	6' X 6'	150	ADVANCE	VEHICLE
		C5	CH25	429325	L - 6F	EB	T	45	6			-	LOOP	6' X 6'	150	ADVANCE	VEHICLE
			CH26	429326	L - 6G	EB	R	45	6			-	LOOP	6' X 6'	330	QUEUE	VEHICLE
		C6	CH27	429327	L - 6H	EB	T	45	6			-	LOOP	6' X 6'	330	QUEUE	VEHICLE
			CH28	429328	L - 6I	EB	T	45	6			-	LOOP	6' X 6'	330	QUEUE	VEHICLE
		C7	CH29	429329	L - 7A	NB	L	35	7			-	LOOP	6' X 40'	0	PRESENCE	VEHICLE
			CH30	429330	L - 7B	NB	L	35	7			-	LOOP	6' X 40'	0	PRESENCE	VEHICLE
		C8	CH31	429331	L - 8	SB	T	9	8			-	LOOP	6' X 40'	0	PRESENCE	VEHICLE
			CH32	429332	L - 8R	SB	R	9	8			5	LOOP	6' X 40'	0	PRESENCE	VEHICLE

ANY CHANNELS NOT SHOWN WILL BE SPARES.

SR 434 AT FLORIDA CENTRAL PKWY. (INT. NO. 4293)
SEMINOLE COUNTY SECTION 77120 AT MP. 7.473

REVISIONS				ENGINEER OF RECORD	STATE OF FLORIDA DEPARTMENT OF TRANSPORTATION			SIGNALIZATION PLAN (8)	
DATE	DESCRIPTION		DATE	DESCRIPTION		ROAD NO.	COUNTY		FINANCIAL PROJECT ID
				ALEX W. HINKLE, P.E. LICENSE NUMBER: 82354 PROTEAN DESIGN GROUP 100 EAST PINE STREET, SUITE 600 ORLANDO, FL 32801		SR 434	SEMINOLE		443838-1-52-01

T-10

THE OFFICIAL RECORD OF THIS SHEET IS THE ELECTRONIC FILE DIGITALLY SIGNED AND SEALED UNDER RULE 61G15-23.004, F.A.C.

1. UTILIZE EXISTING CONDUIT & PULL BOX TO ROUTE PROPOSED CABLING TO EXISTING SIGNAL CABINET.
2. THE ADVANCE LOOPS/SPLICE BOXES ARE NOT POSITIONED AS INDICATED BY THE BASELINE OR SURVEY BUT ARE PLACED AT THE SHOWN DISTANCE.

632-7-6 1 PI

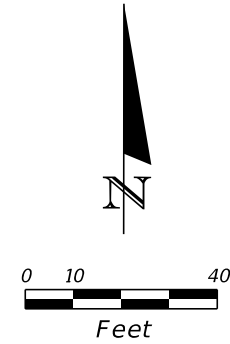

SR 434 AT GRANT ST. (INT. NO. 4287)
SEMINOLE COUNTY SECTION 77120 AT MP. 8.370

REVISIONS				ENGINEER OF RECORD	STATE OF FLORIDA DEPARTMENT OF TRANSPORTATION			SIGNALIZATION PLAN (9)	SHEET NO.
DATE	DESCRIPTION	DATE	DESCRIPTION	ALEX W. HINKLE, P.E. LICENSE NUMBER: 82354 PROTEAN DESIGN GROUP 100 EAST PINE STREET, SUITE 600 ORLANDO, FL 32801	ROAD NO.	COUNTY	FINANCIAL PROJECT ID		T-11
					SR 434	SEMINOLE	443838-1-52-01		

4/17/2025 5:15:09 PM jpantoja
T:\Worksets\FD0T\44383815201\Signalization\PLANS\G01.dgn

THE OFFICIAL RECORD OF THIS SHEET IS THE ELECTRONIC FILE DIGITALLY SIGNED AND SEALED UNDER RULE 61G15-23.004, F.A.C.

4/17/2025 5:15:29 PM jparto\ja T:\Worksets\FDOT\4438381\5201\Signalization\PLAN5G02.dgn

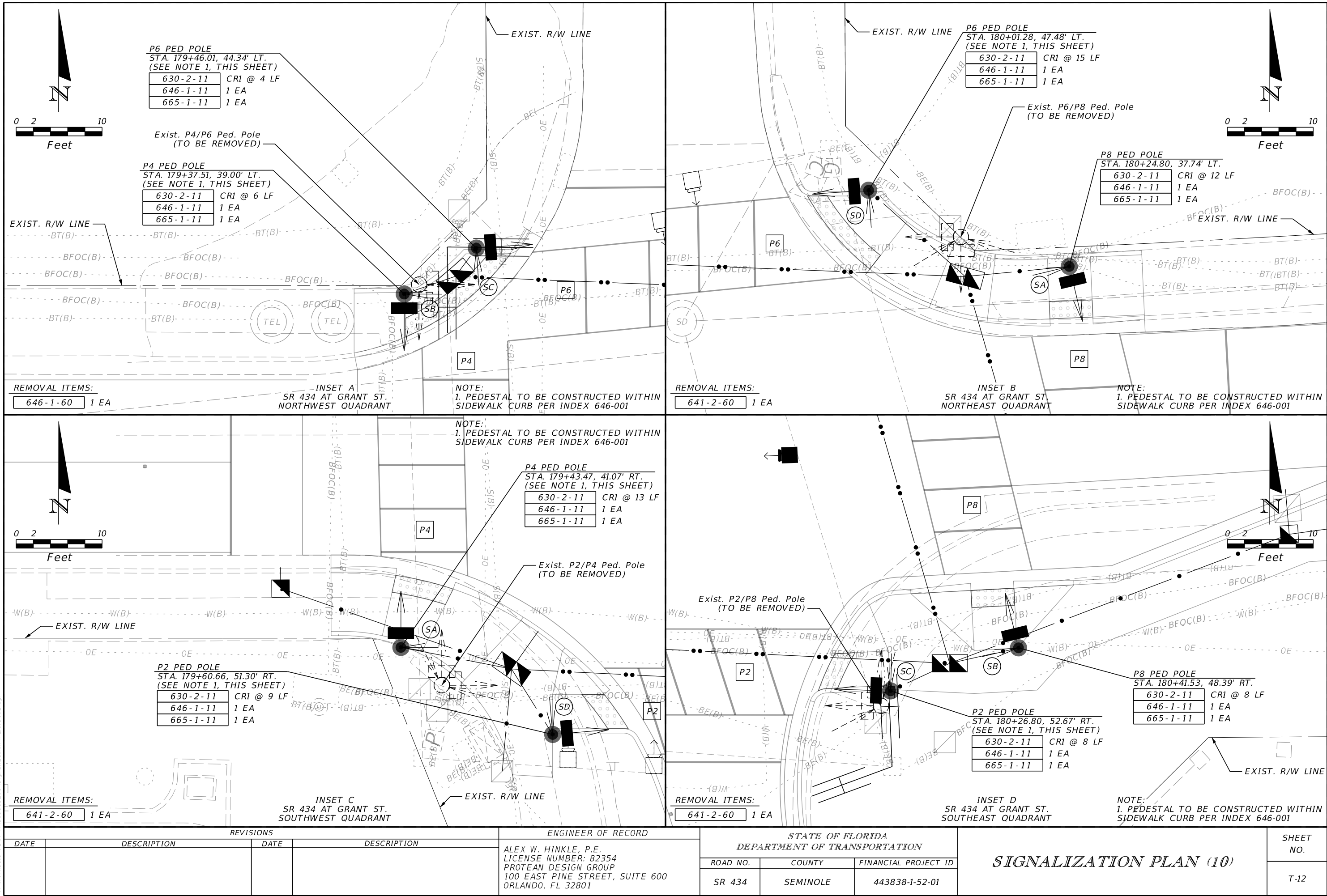

THE OFFICIAL RECORD OF THIS SHEET IS THE ELECTRONIC FILE DIGITALLY SIGNED AND SEALED UNDER RULE 61G15-23.004, F.A.C.

NOTES:

1. THE MAJOR STREET IS SR 434, MOVEMENTS 2 AND 6.
THE MINOR STREET IS GRANT STREET, MOVEMENTS 4 AND 8.
2. MODIFIED SIGNAL OPERATING PLAN 7 IS TO REMAIN AS SHOWN BELOW.
3. POSTED SPEEDS:
- SR 434: 45 MPH
- GRANT STREET: 25 MPH

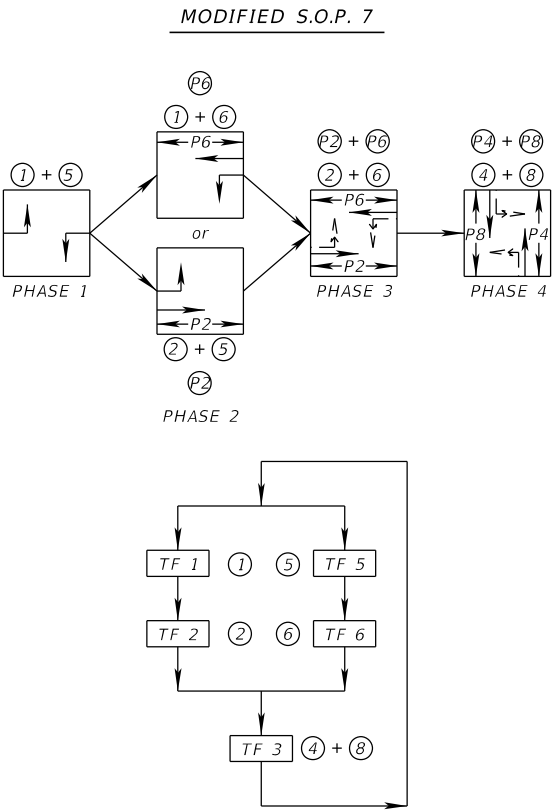

TABLE 1: CONTROLLER TIMINGS						
MOVEMENT NUMBER	1	2	4	5	6	8
DIRECTION	WBL	EB	SB	EBL	WB	NB
MINIMUM GREEN*	6	15	8	6	15	8
PASSAGE*	3.0	4.0	3.0	3.0	4.0	3.0
YELLOW	4.8	4.8	3.4	4.8	4.8	3.4
ALL RED	2.5	2.0	2.5	2.0	2.0	2.5
MAX I*	25	60	35	25	60	35
WALK		7.0	7.0		7.0	7.0
FLASH DON'T WALK		16.0	21.0		15.0	22.0
RECALL*		MIN			MIN	

*DENOTES EXISTING VALUE TO REMAIN

INTERNALLY ILLUMINATED STREET NAME SIGNS



EXISTING SPAN WIRE MOUNTED SIGNS

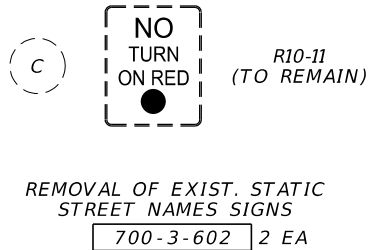

TRAFFIC SIGNAL HEAD DETAILS

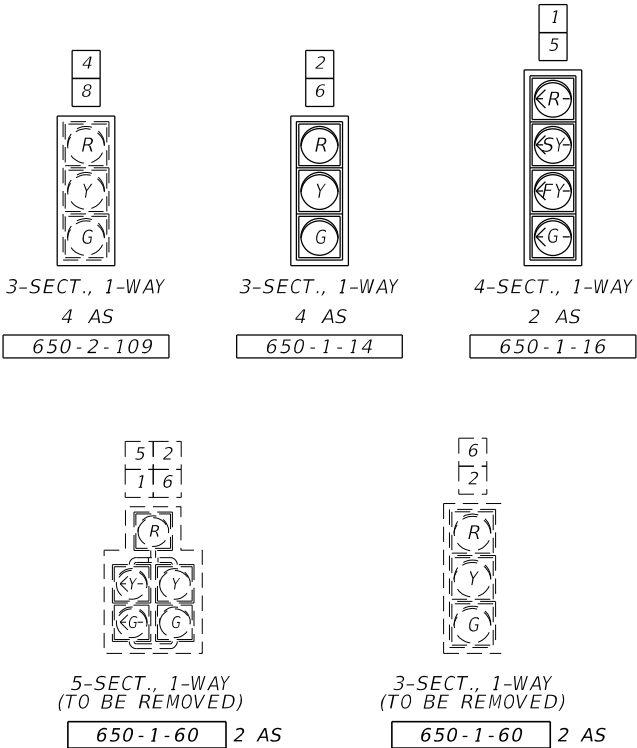

PEDESTRIAN SIGNAL HEADS AND SIGN DETAILS

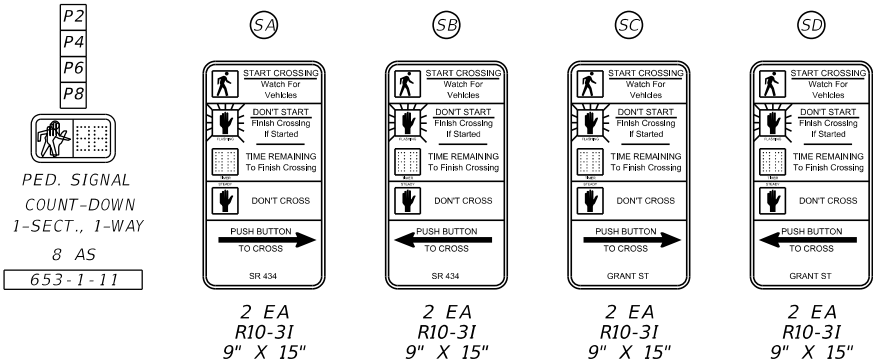

4/17/2025 5:15:40 PM jparto\ja T:\Worksets\FDOT\4438381\5201\Signalization\PLANS\G03.dgn

SIGNAL ID	BIU NO.	CARD NO.	CHANNEL NO.	DETECTOR ID	DETECTOR	DIRECTION	MOVEMENT TYPE	APP. SPEED (MPH)	PROTECTED PHASE	PERMISSIVE PHASE	OVERLAP	DELAY (SEC)	DETECTOR SYSTEM	ZONE SIZE	DISTANCE TO STOP BAR (FT)	DETECTOR TYPE	LANE TYPE
4287	1	C1	CH1	428701	L - 1A	WB	L	45	1			-	LOOP	6' X 40'	0	PRESENCE	VEHICLE
			CH2	428702	L - 1B	WB	L	45	1			-	LOOP	6' X 6'	150	ADVANCE	VEHICLE
		C2	CH3	428703	L - 2A	EB	T	45	2	1		-	LOOP	6' X 40'	0	PRESENCE	VEHICLE
			CH4	428704	L - 2B	EB	T	45	2	1		-	LOOP	6' X 40'	0	PRESENCE	VEHICLE
		C3	CH5	428705	L - 2C	EB	T	45	2	1		-	LOOP	6' X 6'	150	ADVANCE	VEHICLE
			CH6	428706	L - 2D	EB	T	45	2	1		-	LOOP	6' X 6'	150	ADVANCE	VEHICLE
		C4	CH7	428707	L - 2E	EB	T	45	2	1		-	LOOP	6' X 6'	330	QUEUE	VEHICLE
			CH8	428708	L - 2F	EB	T	45	2	1		-	LOOP	6' X 6'	330	QUEUE	VEHICLE
		C5	CH9	428709	L - 4	SB	TLR	25	4			5	LOOP	6' X 40'	0	PRESENCE	VEHICLE
			CH10	428710	L - 5A	EB	L	45	5			-	LOOP	6' X 40'	0	PRESENCE	VEHICLE
		C6	CH11	428711	L - 5B	EB	L	45	5			-	LOOP	6' X 6'	150	ADVANCE	VEHICLE
			CH12	428712	L - 6A	WB	T	45	6	5		-	LOOP	6' X 40'	0	PRESENCE	VEHICLE
		C7	CH13	428713	L - 6B	WB	T	45	6	5		-	LOOP	6' X 40'	0	PRESENCE	VEHICLE
			CH14	428714	L - 6C	WB	T	45	6	5		-	LOOP	6' X 6'	150	ADVANCE	VEHICLE
		C8	CH15	428715	L - 6D	WB	T	45	6	5		-	LOOP	6' X 6'	150	ADVANCE	VEHICLE
			CH16	428716	L - 6E	WB	T	45	6	5		-	LOOP	6' X 6'	330	QUEUE	VEHICLE
	2	C1	CH17	428717	L - 6F	WB	T	45	6	5		-	LOOP	6' X 6'	330	QUEUE	VEHICLE
			CH18	428718	L - 8	NB	LT	25	8			-	LOOP	6' X 40'	0	PRESENCE	VEHICLE
		C2	CH19	428719	L - 8R	NB	R	25	8			5	LOOP	6' X 40'	0	PRESENCE	VEHICLE
			CH20	428720	SPARE												
		C3	CH21	428721	SPARE												
			CH22	428722	SPARE												
		C4	CH23	428723	SPARE												
			CH24	428724	SPARE												
		C5	CH25	428725	SPARE												
			CH26	428726	SPARE												
		C6	CH27	428727	SPARE												
			CH28	428728	SPARE												
		C7	CH29	428729	SPARE												
			CH30	428730	SPARE												
		C8	CH31	428731	SPARE												
			CH32	428732	SPARE												

ANY CHANNELS NOT SHOWN WILL BE SPARES.

SR 434 AT GRANT ST. (INT. NO. 4287)
SEMINOLE COUNTY SECTION 77120 AT MP. 8.370

REVISIONS				ENGINEER OF RECORD	STATE OF FLORIDA DEPARTMENT OF TRANSPORTATION			SIGNALIZATION PLAN (12)	
DATE	DESCRIPTION		DATE	DESCRIPTION		ROAD NO.	COUNTY		FINANCIAL PROJECT ID
				ALEX W. HINKLE, P.E. LICENSE NUMBER: 82354 PROTEAN DESIGN GROUP 100 EAST PINE STREET, SUITE 600 ORLANDO, FL 32801		SR 434	SEMINOLE		443838-1-52-01

T-14

THE OFFICIAL RECORD OF THIS SHEET IS THE ELECTRONIC FILE DIGITALLY SIGNED AND SEALED UNDER RULE 61G15-23.004, F.A.C.

NOTES:

1. UTILIZE EXISTING CONDUIT & PULL BOX TO ROUTE PROPOSED CABLING TO EXISTING SIGNAL CABINET.
2. THE ADVANCE LOOPS/SPLICE BOXES ARE NOT POSITIONED AS INDICATED BY THE BASELINE OR SURVEY BUT ARE PLACED AT THE SHOWN DISTANCE.

REMOVAL ITEMS:

632-7-6	1 PI
660-1-600	1 EA

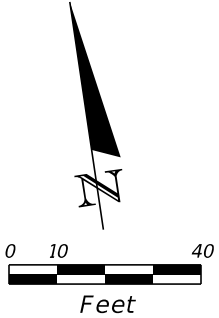
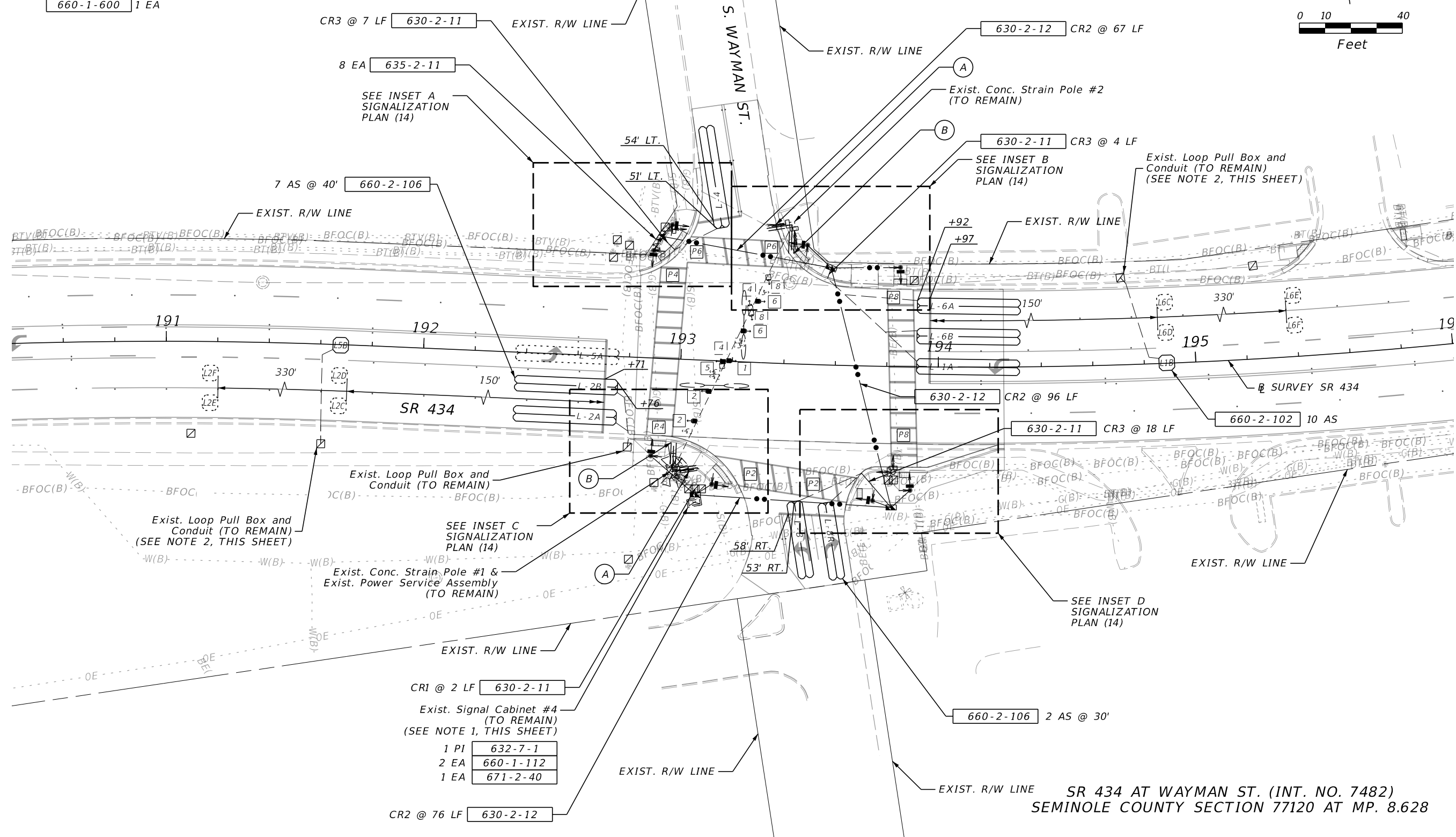

4/17/2025 5:16:20 PM jparto\ja T:\Worksets\FDOT\4438381\Signalization\PLANS\G01.dgn

REVISIONS				ENGINEER OF RECORD	STATE OF FLORIDA DEPARTMENT OF TRANSPORTATION			SHEET NO.
DATE	DESCRIPTION	DATE	DESCRIPTION		ROAD NO.	COUNTY	FINANCIAL PROJECT ID	
					SR 434	SEMINOLE	443838-1-52-01	

ALEX W. HINKLE, P.E.
LICENSE NUMBER: 82354
PROTEAN DESIGN GROUP
100 EAST PINE STREET, SUITE 600
ORLANDO, FL 32801

SIGNALIZATION PLAN (13)

T-15

THE OFFICIAL RECORD OF THIS SHEET IS THE ELECTRONIC FILE DIGITALLY SIGNED AND SEALED UNDER RULE 61G15-23.004, F.A.C.

4/17/2025 5:16:40 PM jparto\ja T:\Worksets\FDOT\4438381\Signalization\PLAN5G02.dgn

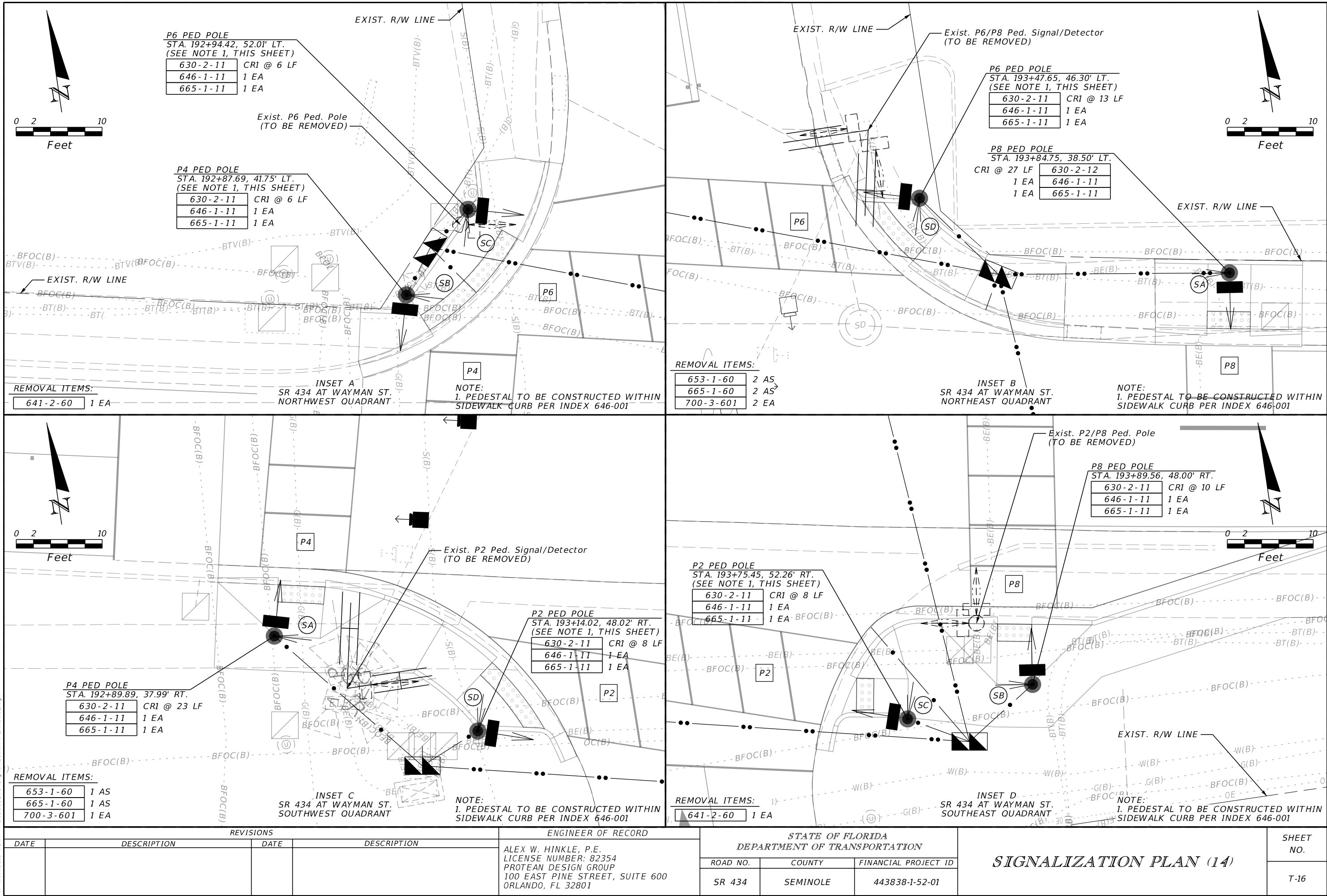

REVISIONS			
DATE	DESCRIPTION	DATE	DESCRIPTION

ENGINEER OF RECORD
ALEX W. HINKLE, P.E.
LICENSE NUMBER: 82354
PROTEAN DESIGN GROUP
100 EAST PINE STREET, SUITE 600
ORLANDO, FL 32801

STATE OF FLORIDA DEPARTMENT OF TRANSPORTATION		
ROAD NO.	COUNTY	FINANCIAL PROJECT ID
SR 434	SEMINOLE	443838-1-52-01

SIGNALIZATION PLAN (14)

SHEET NO.
T-16

THE OFFICIAL RECORD OF THIS SHEET IS THE ELECTRONIC FILE DIGITALLY SIGNED AND SEALED UNDER RULE 61G15-23.004, F.A.C.

NOTES:

1. THE MAJOR STREET IS SR 434, MOVEMENTS 2 AND 6.
THE MINOR STREET IS WAYMAN STREET, MOVEMENTS 4 AND 8.
2. MODIFIED SIGNAL OPERATING PLAN 7 IS TO REMAIN AS SHOWN BELOW.
3. POSTED SPEEDS:
- SR 434: 45 MPH
- WAYMAN STREET: 25 MPH

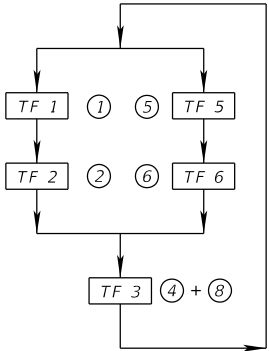
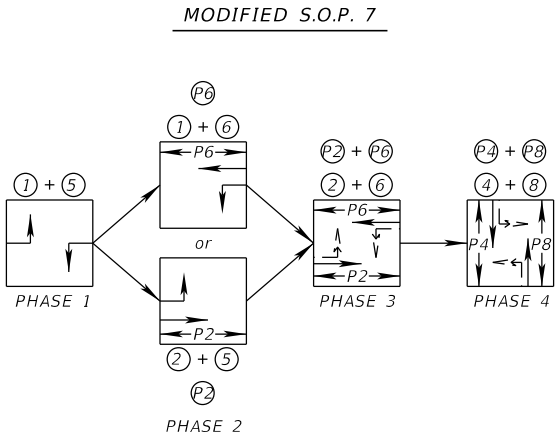

TABLE 1: CONTROLLER TIMINGS

MOVEMENT NUMBER	1	2	4	5	6	8
DIRECTION	WBL	EB	SB	EBL	WB	NB
MINIMUM GREEN*	6	15	8	6	15	8
PASSAGE*	3.0	4.0	3.0	3.0	4.0	3.0
YELLOW	4.8	4.8	3.4	4.8	4.8	3.4
ALL RED	2.3	2.0	2.6	2.1	2.0	2.5
MAX I*	20	60	30	20	60	30
WALK		7.0	8.0		7.0	7.0
FLASH DON'T WALK		16.0	22.0		13.0	21.0
RECALL		MIN			MIN	

*DENOTES EXISTING VALUE TO REMAIN

INTERNALLY ILLUMINATED STREET NAME SIGNS



REMOVAL OF EXIST. INTERNALLY
ILLUMINATED STREET NAMES SIGNS
700-5-60 4 EA

TRAFFIC SIGNAL HEAD DETAILS

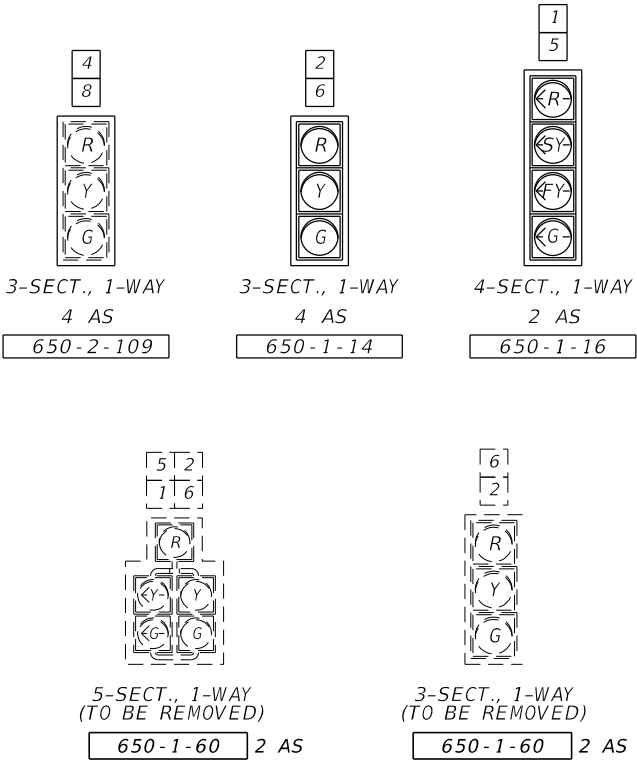

PEDESTRIAN SIGNAL HEADS AND SIGN DETAILS

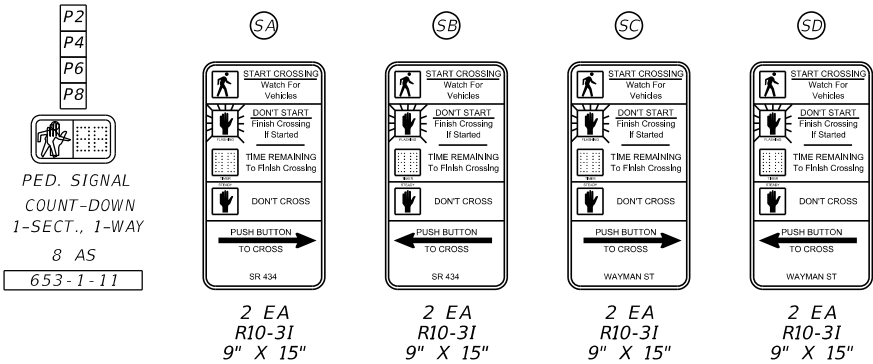

4/17/2025 5:16:52 PM jparto\ja T:\Worksets\FDOT\4438381\5201\Signalization\PLANS\G03.dgn

SIGNAL ID	BIU NO.	CARD NO.	CHANNEL NO.	DETECTOR ID	DETECTOR	DIRECTION	MOVEMENT TYPE	APP. SPEED (MPH)	PROTECTED PHASE	PERMISSIVE PHASE	OVERLAP	DELAY (SEC)	DETECTOR SYSTEM	ZONE SIZE	DISTANCE TO STOP BAR (FT)	DETECTOR TYPE	LANE TYPE
7482	1	C1	CH1	748201	L - 1A	WB	L	45	1			-	LOOP	6' X 40'	0	PRESENCE	VEHICLE
			CH2	748202	L - 1B	WB	L	45	1			-	LOOP	6' X 6'	150	ADVANCE	VEHICLE
		C2	CH3	748203	L - 2A	EB	T	45	2	1		-	LOOP	6' X 40'	0	PRESENCE	VEHICLE
			CH4	748204	L - 2B	EB	T	45	2	1		-	LOOP	6' X 40'	0	PRESENCE	VEHICLE
		C3	CH5	748205	L - 2C	EB	T	45	2	1		-	LOOP	6' X 6'	150	ADVANCE	VEHICLE
			CH6	748206	L - 2D	EB	T	45	2	1		-	LOOP	6' X 6'	150	ADVANCE	VEHICLE
		C4	CH7	748207	L - 2E	EB	T	45	2	1		-	LOOP	6' X 6'	330	QUEUE	VEHICLE
			CH8	748208	L - 2F	EB	T	45	2	1		-	LOOP	6' X 6'	330	QUEUE	VEHICLE
		C5	CH9	748209	L - 4	SB	TLR	25	4			5	LOOP	6' X 40'	0	PRESENCE	VEHICLE
			CH10	748210	L - 5A	EB	L	45	5			-	LOOP	6' X 40'	0	PRESENCE	VEHICLE
		C6	CH11	748211	L - 5B	EB	L	45	5			-	LOOP	6' X 6'	150	ADVANCE	VEHICLE
			CH12	748212	L - 6A	WB	T	45	6	5		-	LOOP	6' X 40'	0	PRESENCE	VEHICLE
		C7	CH13	748213	L - 6B	WB	T	45	6	5		-	LOOP	6' X 40'	0	PRESENCE	VEHICLE
			CH14	748214	L - 6C	WB	T	45	6	5		-	LOOP	6' X 6'	150	ADVANCE	VEHICLE
			CH15	748215	L - 6D	WB	T	45	6	5		-	LOOP	6' X 6'	150	ADVANCE	VEHICLE
			CH16	748216	L - 6E	WB	T	45	6	5		-	LOOP	6' X 6'	330	QUEUE	VEHICLE
		C8	CH17	748217	L - 6F	WB	T	45	6	5		-	LOOP	6' X 6'	330	QUEUE	VEHICLE
			CH18	748218	L - 8	NB	LT	25	8			-	LOOP	6' X 40'	0	PRESENCE	VEHICLE
			CH19	748219	L - 8R	NB	R	25	8			5	LOOP	6' X 40'	0	PRESENCE	VEHICLE
			CH20	748220	SPARE												

ANY CHANNELS NOT SHOWN WILL BE SPARES.

SR 434 AT WAYMAN ST. (INT. NO. 7482)
SEMINOLE COUNTY SECTION 77120 AT MP. 8.628

REVISIONS				ENGINEER OF RECORD	STATE OF FLORIDA DEPARTMENT OF TRANSPORTATION			SIGNALIZATION PLAN (16)	
DATE	DESCRIPTION		DATE	DESCRIPTION		ROAD NO.	COUNTY		FINANCIAL PROJECT ID
				ALEX W. HINKLE, P.E. LICENSE NUMBER: 82354 PROTEAN DESIGN GROUP 100 EAST PINE STREET, SUITE 600 ORLANDO, FL 32801		SR 434	SEMINOLE		443838-1-52-01

T-18

THE OFFICIAL RECORD OF THIS SHEET IS THE ELECTRONIC FILE DIGITALLY SIGNED AND SEALED UNDER RULE 61G15-23.004, F.A.C.

1. UTILIZE EXISTING CONDUIT & PULL BOX TO ROUTE PROPOSED CABLING TO EXISTING SIGNAL CABINET.
2. THE ADVANCE LOOPS/SPLICE BOXES ARE NOT POSITIONED AS INDICATED BY THE BASELINE OR SURVEY BUT ARE PLACED AT THE SHOWN DISTANCE.

632-7-6	1 PI
660-1-600	13 EA

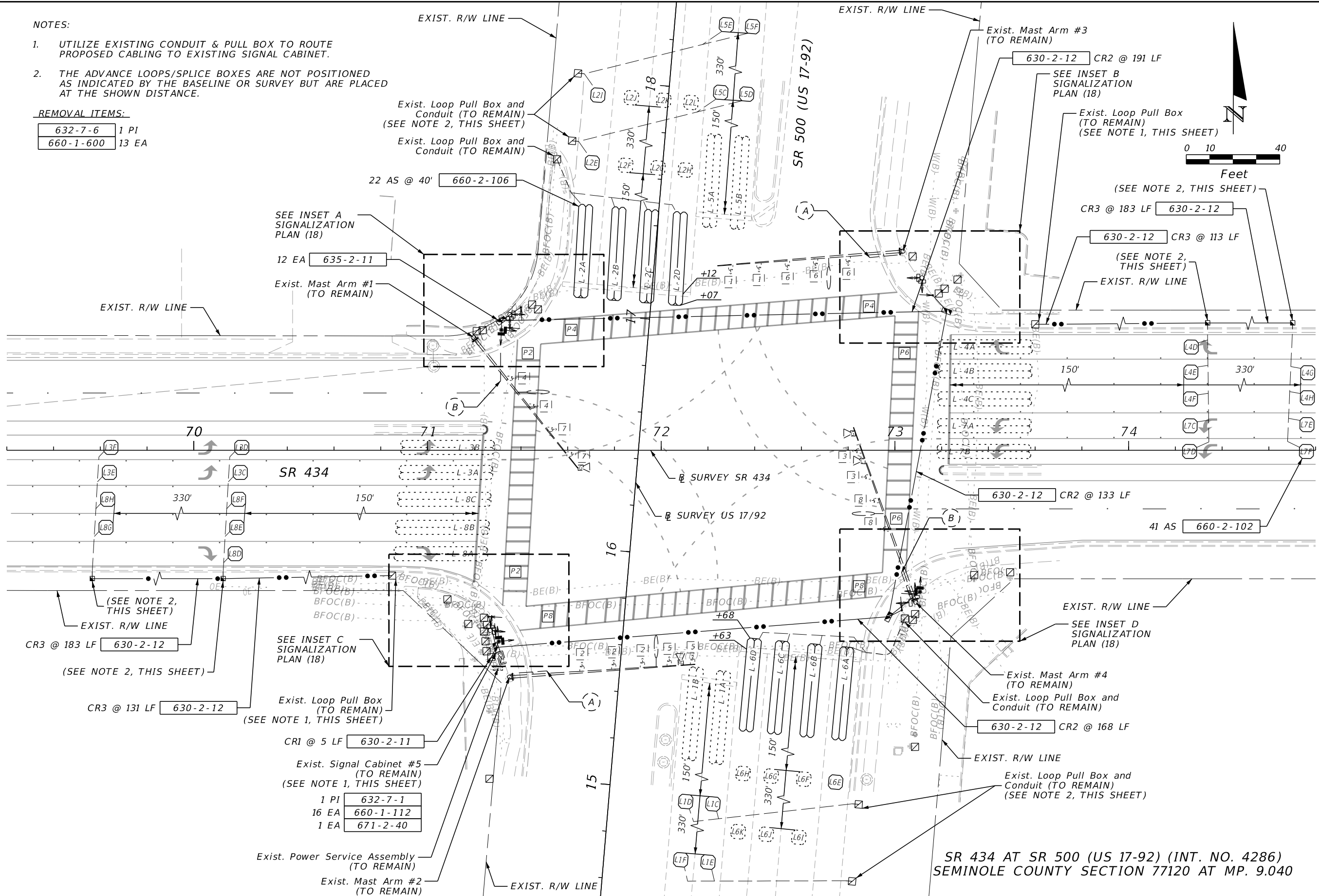

REVISIONS				ENGINEER OF RECORD	STATE OF FLORIDA DEPARTMENT OF TRANSPORTATION			SIGNALIZATION PLAN (17)	SHEET NO.
DATE	DESCRIPTION	DATE	DESCRIPTION	ALEX W. HINKLE, P.E. LICENSE NUMBER: 82354 PROTEAN DESIGN GROUP 100 EAST PINE STREET, SUITE 600 ORLANDO, FL 32801	ROAD NO.	COUNTY	FINANCIAL PROJECT ID		T-19
					SR 434	SEMINOLE	443838-1-52-01		

4/17/2025 5:17:20 PM jpantoja
T:\Worksets\FD0T\44383815201\Signalization\PLANS\G01.dgn

THE OFFICIAL RECORD OF THIS SHEET IS THE ELECTRONIC FILE DIGITALLY SIGNED AND SEALED UNDER RULE 61G15-23.004, F.A.C.

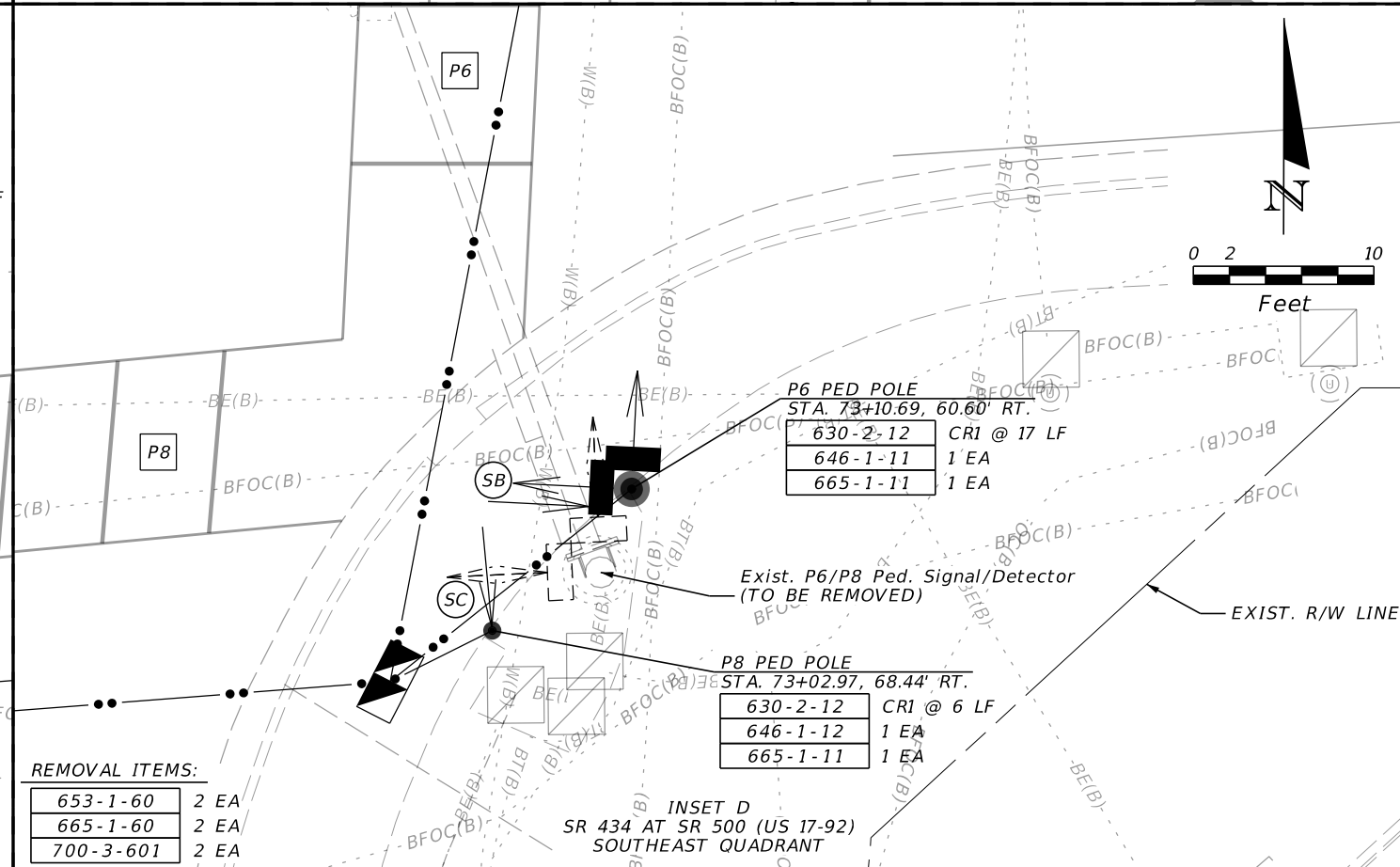
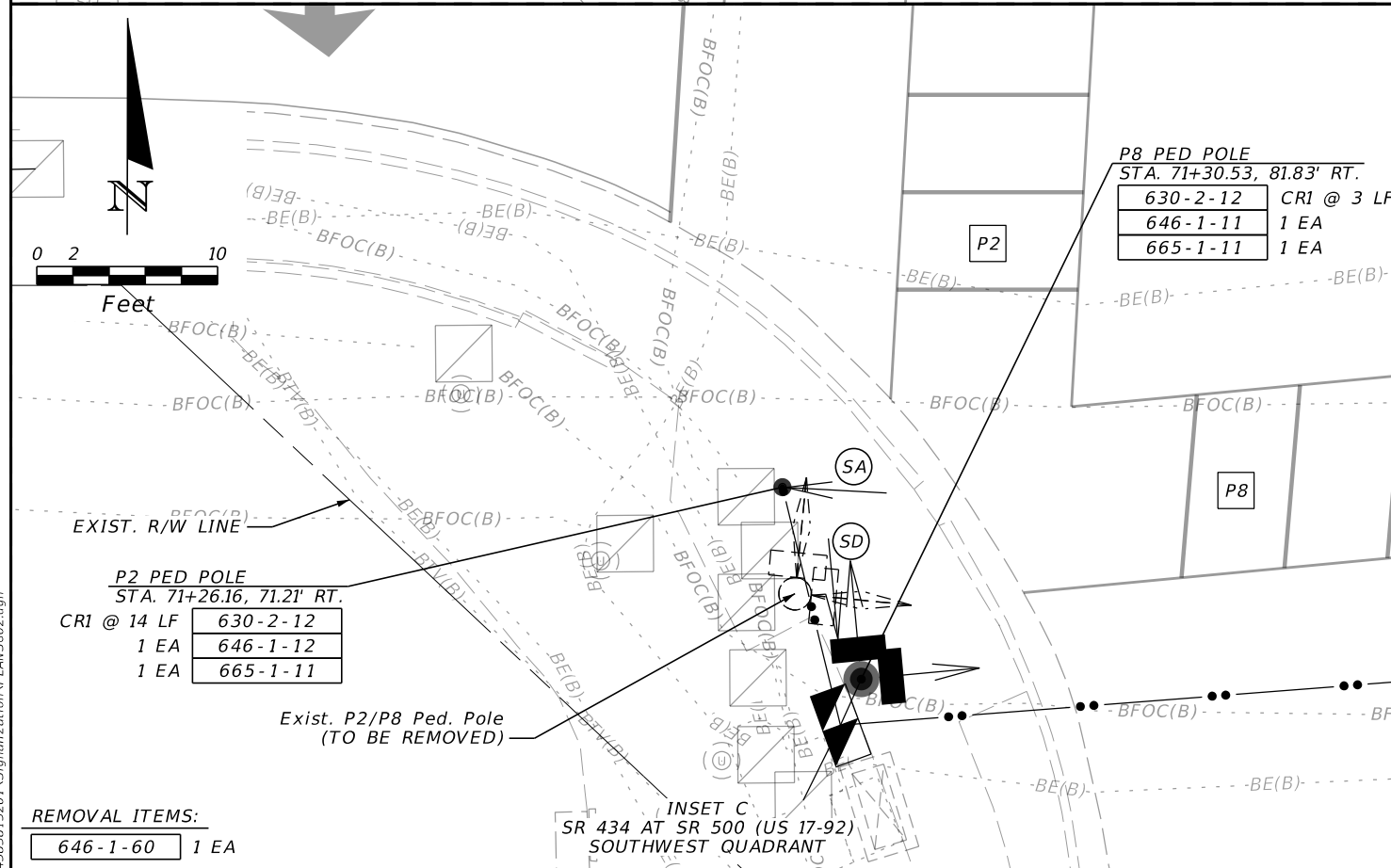
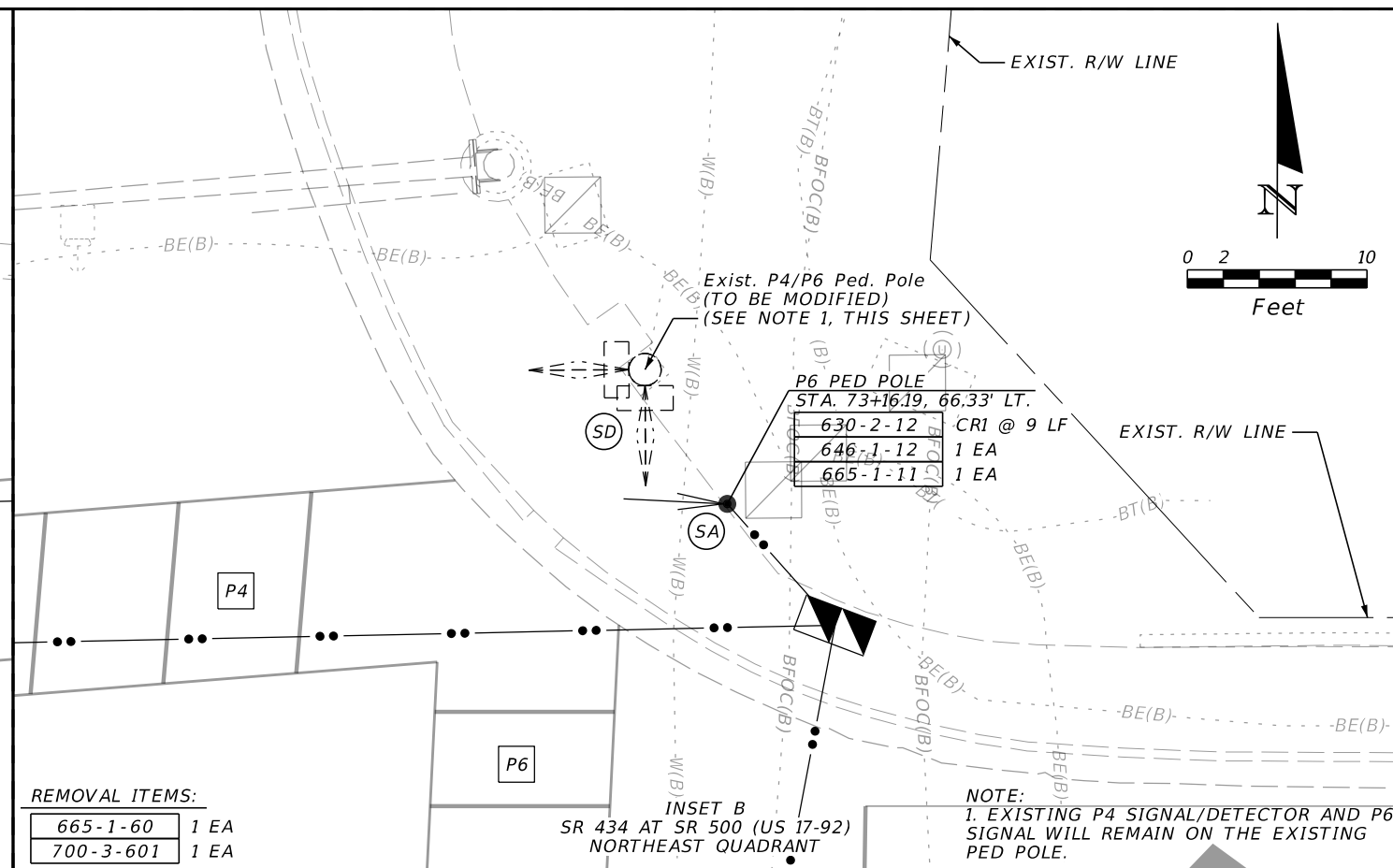
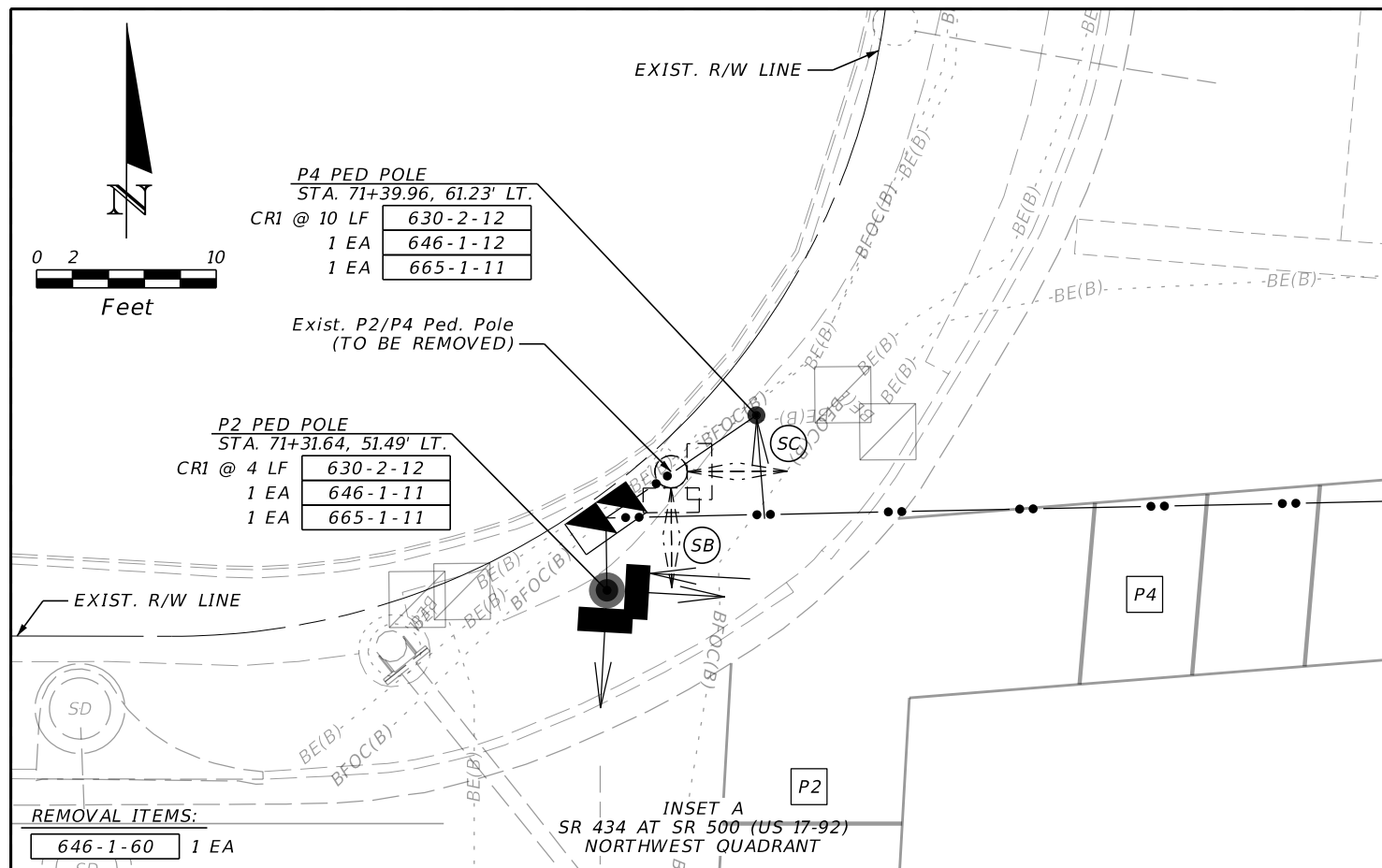

REVISIONS				ENGINEER OF RECORD		STATE OF FLORIDA DEPARTMENT OF TRANSPORTATION			<div style="text-align: center; font-size: 24pt; font-weight: bold;"> <i>SIGNALIZATION PLAN (18)</i> </div>	SHEET NO.
DATE	DESCRIPTION	DATE	DESCRIPTION	ALEX W. HINKLE, P.E. LICENSE NUMBER: 82354 PROTEAN DESIGN GROUP 100 EAST PINE STREET, SUITE 600 ORLANDO, FL 32801		ROAD NO.	COUNTY	FINANCIAL PROJECT ID		T-20
						SR 434	SEMINOLE	443838-1-52-01		

NOTES:

- THE MAJOR STREET IS SR 434, MOVEMENTS 2 AND 6.
THE MINOR STREET IS US 17-92, MOVEMENTS 4 AND 8.
- STANDARD SIGNAL OPERATING PLAN 10 IS TO REMAIN AS SHOWN BELOW.
- POSTED SPEEDS:
- SR 434: 45 MPH
- US 17-92: 45 MPH

EXISTING STREET NAME SIGNS



EXISTING SIGN
(TO REMAIN)

EXISTING SIGN
(TO REMAIN)

TRAFFIC SIGNAL HEAD DETAILS

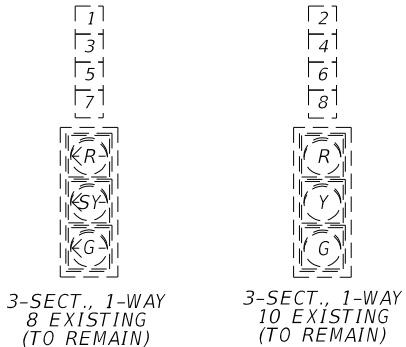

S.O.P. 10

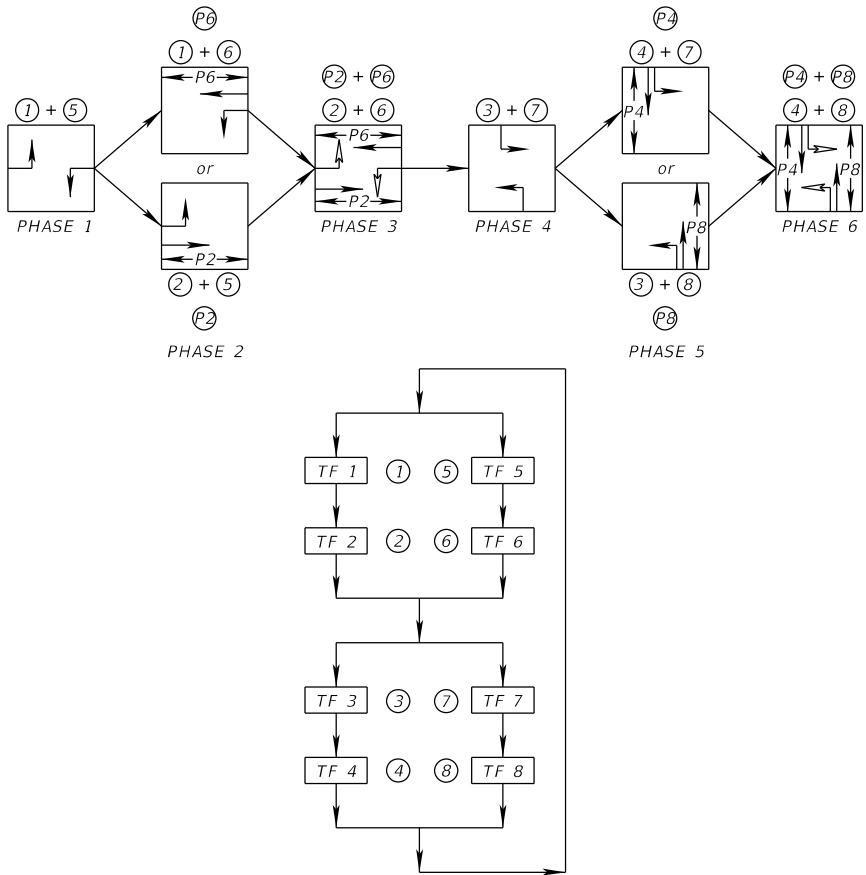

PEDESTRIAN SIGNAL HEADS AND SIGN DETAILS

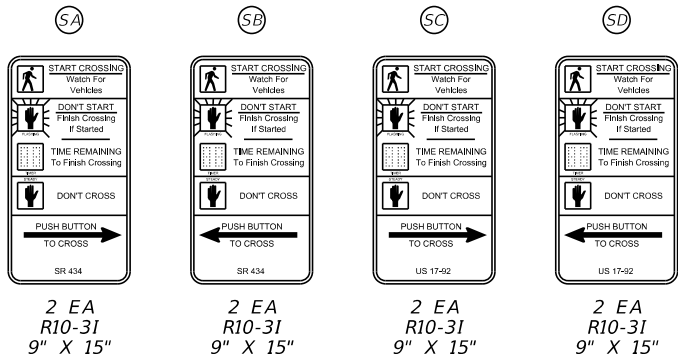
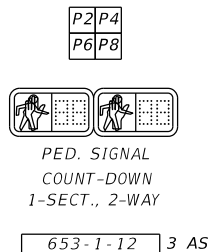

TABLE 1: CONTROLLER TIMINGS

MOVEMENT NUMBER	1	2	3	4	5	6	7	8
DIRECTION	NBL	SB	EBL	WB	SBL	NB	WBL	EB
MINIMUM GREEN*	6	15	6	8	6	15	6	8
EXTENSION*	3.0	4.0	3.0	3.5	3.0	4.0	3.0	3.5
YELLOW	4.8	4.8	4.8	4.8	4.8	4.8	4.8	4.8
ALL RED	4.8	2.0	4.5	2.2	4.5	2.0	4.6	2.1
MAX I*	25	95	30	70	30	90	50	50
WALK		10.0		11.0		9.0		12.0
FLASH DON'T WALK		36.0		47.0		36.0		48.0
RECALL		MIN				MIN		

*DENOTES EXISTING VALUE TO REMAIN

SR 434 AT SR 500 (US 17-92) (INT. NO. 4286)
SEMINOLE COUNTY SECTION 77120 AT MP. 9.040

REVISIONS				ENGINEER OF RECORD	STATE OF FLORIDA DEPARTMENT OF TRANSPORTATION			SIGNALIZATION PLAN (19)	SHEET NO.	
DATE	DESCRIPTION		DATE	DESCRIPTION					ROAD NO.	COUNTY
						ALEX W. HINKLE, P.E. LICENSE NUMBER: 82354 PROTEAN DESIGN GROUP 100 EAST PINE STREET, SUITE 600 ORLANDO, FL 32801	SR 434		SEMINOLE	443838-1-52-01

T-21

4/17/2025 5:17:55 PM jparto\ja T:\Worksets\FDOT\4438381\5201\Signalization\PLANS\G03.dgn

SIGNAL ID	BIU NO.	CARD NO.	CHANNEL NO.	DETECTOR ID	DETECTOR	DIRECTION	MOVEMENT TYPE	APP. SPEED (MPH)	PROTECTED PHASE	PERMISSIVE PHASE	OVERLAP	DELAY (SEC)	DETECTOR SYSTEM	ZONE SIZE	DISTANCE TO STOP BAR (FT)	DETECTOR TYPE	LANE TYPE
4286	1	C1	CH1	428601	L-1A	NB	L	45	1			-	LOOP	6' X 40'	0	PRESENCE	VEHICLE
			CH2	428602	L-1B	NB	L	45	1			-	LOOP	6' X 40'	0	PRESENCE	VEHICLE
			CH3	428603	L-1C	NB	L	45	1			-	LOOP	6' X 6'	150	ADVANCE	VEHICLE
			CH4	428604	L-1D	NB	L	45	1			-	LOOP	6' X 6'	150	ADVANCE	VEHICLE
		C2	CH5	428605	L-1E	NB	L	45	1			-	LOOP	6' X 6'	330	QUEUE	VEHICLE
			CH6	428606	L-1F	NB	L	45	1			-	LOOP	6' X 6'	330	QUEUE	VEHICLE
			CH7	428607	L-2A	SB	R	45	2			5	LOOP	6' X 40'	0	PRESENCE	VEHICLE
			CH8	428608	L-2B	SB	T	45	2			-	LOOP	6' X 40'	0	PRESENCE	VEHICLE
		C3	CH9	428609	L-2C	SB	T	45	2			-	LOOP	6' X 40'	0	PRESENCE	VEHICLE
			CH10	428610	L-2D	SB	T	45	2			-	LOOP	6' X 40'	0	PRESENCE	VEHICLE
			CH11	428611	L-2E	SB	R	45	2			-	LOOP	6' X 6'	150	ADVANCE	VEHICLE
			CH12	428612	L-2F	SB	T	45	2			-	LOOP	6' X 6'	150	ADVANCE	VEHICLE
		C4	CH13	428613	L-2G	SB	T	45	2			-	LOOP	6' X 6'	150	ADVANCE	VEHICLE
			CH14	428614	L-2H	SB	T	45	2			-	LOOP	6' X 6'	150	ADVANCE	VEHICLE
			CH15	428615	L-2I	SB	R	45	2			-	LOOP	6' X 6'	330	QUEUE	VEHICLE
			CH16	428616	L-2J	SB	T	45	2			-	LOOP	6' X 6'	330	QUEUE	VEHICLE
		C5	CH17	428617	L-2K	SB	T	45	2			-	LOOP	6' X 6'	330	QUEUE	VEHICLE
			CH18	428618	L-2L	SB	T	45	2			-	LOOP	6' X 6'	330	QUEUE	VEHICLE
			CH19	428619	L-3A	EB	L	45	3			-	LOOP	6' X 40'	0	PRESENCE	VEHICLE
			CH20	428620	L-3B	EB	L	45	3			-	LOOP	6' X 40'	0	PRESENCE	VEHICLE
		C6	CH21	428621	L-3C	EB	L	45	3			-	LOOP	6' X 6'	150	ADVANCE	VEHICLE
			CH22	428622	L-3D	EB	L	45	3			-	LOOP	6' X 6'	150	ADVANCE	VEHICLE
			CH23	428623	L-3E	EB	L	45	3			-	LOOP	6' X 6'	330	QUEUE	VEHICLE
			CH24	428624	L-3F	EB	L	45	3			-	LOOP	6' X 6'	330	QUEUE	VEHICLE
		C7	CH25	428625	L-4A	WB	R	45	4			5	LOOP	6' X 40'	0	PRESENCE	VEHICLE
			CH26	428626	L-4B	WB	T	45	4			-	LOOP	6' X 40'	0	PRESENCE	VEHICLE
			CH27	428627	L-4C	WB	T	45	4			-	LOOP	6' X 40'	0	PRESENCE	VEHICLE
			CH28	428628	L-4D	WB	R	45	4			-	LOOP	6' X 6'	150	ADVANCE	VEHICLE
		C8	CH29	428629	L-4E	WB	T	45	4			-	LOOP	6' X 6'	150	ADVANCE	VEHICLE
			CH30	428630	L-4F	WB	T	45	4			-	LOOP	6' X 6'	150	ADVANCE	VEHICLE
			CH31	428631	L-4G	WB	T	45	4			-	LOOP	6' X 6'	330	QUEUE	VEHICLE
			CH32	428632	L-4H	WB	T	45	4			-	LOOP	6' X 6'	330	QUEUE	VEHICLE
	2	C1	CH33	428633	L-5A	SB	L	45	5			-	LOOP	6' X 40'	0	PRESENCE	VEHICLE
			CH34	428634	L-5B	SB	L	45	5			-	LOOP	6' X 40'	0	PRESENCE	VEHICLE
			CH35	428635	L-5C	SB	L	45	5			-	LOOP	6' X 6'	150	ADVANCE	VEHICLE
			CH36	428636	L-5D	SB	L	45	5			-	LOOP	6' X 6'	150	ADVANCE	VEHICLE
		C2	CH37	428637	L-5E	SB	L	45	5			-	LOOP	6' X 6'	330	QUEUE	VEHICLE
			CH38	428638	L-5F	SB	L	45	5			-	LOOP	6' X 6'	330	QUEUE	VEHICLE
			CH39	428639	L-6A	NB	R	45	6			5	LOOP	6' X 40'	0	PRESENCE	VEHICLE
			CH40	428640	L-6B	NB	T	45	6			-	LOOP	6' X 40'	0	PRESENCE	VEHICLE
		C3	CH41	428641	L-6C	NB	T	45	6			-	LOOP	6' X 40'	0	PRESENCE	VEHICLE
			CH42	428642	L-6D	NB	T	45	6			-	LOOP	6' X 40'	0	PRESENCE	VEHICLE
			CH43	428643	L-6E	NB	R	45	6			-	LOOP	6' X 6'	150	ADVANCE	VEHICLE
			CH44	428644	L-6F	NB	T	45	6			-	LOOP	6' X 6'	150	ADVANCE	VEHICLE
		C4	CH45	428645	L-6G	NB	T	45	6			-	LOOP	6' X 6'	150	ADVANCE	VEHICLE
			CH46	428646	L-6H	NB	T	45	6			-	LOOP	6' X 6'	150	ADVANCE	VEHICLE
			CH47	428647	L-6I	NB	T	45	6			-	LOOP	6' X 6'	330	QUEUE	VEHICLE
			CH48	428648	L-6J	NB	T	45	6			-	LOOP	6' X 6'	330	QUEUE	VEHICLE
		C5	CH49	428649	L-6K	NB	T	45	6			-	LOOP	6' X 6'	330	QUEUE	VEHICLE
			CH50	428650	L-7A	WB	L	45	7			-	LOOP	6' X 40'	0	PRESENCE	VEHICLE
			CH51	428651	L-7B	WB	L	45	7			-	LOOP	6' X 40'	0	PRESENCE	VEHICLE
			CH52	428652	L-7C	WB	L	45	7			-	LOOP	6' X 6'	150	ADVANCE	VEHICLE
		C6	CH53	428653	L-7D	WB	L	45	7			-	LOOP	6' X 6'	150	ADVANCE	VEHICLE
			CH54	428654	L-7E	WB	L	45	7			-	LOOP	6' X 6'	330	QUEUE	VEHICLE
			CH55	428655	L-7F	WB	L	45	7			-	LOOP	6' X 6'	330	QUEUE	VEHICLE
			CH56	428656	L-8A	EB	R	45	8			5	LOOP	6' X 40'	0	PRESENCE	VEHICLE
		C7	CH57	428657	L-8B	EB	T	45	8			-	LOOP	6' X 40'	0	PRESENCE	VEHICLE
			CH58	428658	L-8C	EB	T	45	8			-	LOOP	6' X 40'	0	PRESENCE	VEHICLE
			CH59	428659	L-8D	EB	R	45	8			-	LOOP	6' X 6'	150	ADVANCE	VEHICLE
			CH60	428660	L-8E	EB	T	45	8			-	LOOP	6' X 6'	150	ADVANCE	VEHICLE
		C8	CH61	428661	L-8F	EB	T	45	8			-	LOOP	6' X 6'	150	ADVANCE	VEHICLE
			CH62	428662	L-8G	EB	T	45	8			-	LOOP	6' X 6'	330	QUEUE	VEHICLE
			CH63	428663	L-8H	EB	T	45	8			-	LOOP	6' X 6'	330	QUEUE	VEHICLE
			CH64	428664	SPARE												

SR 434 AT SR 500 (US 17-92) (INT. NO. 4286)
SEMINOLE COUNTY SECTION 77120 AT MP. 9.040

REVISIONS				ENGINEER OF RECORD	STATE OF FLORIDA DEPARTMENT OF TRANSPORTATION			SIGNALIZATION PLAN (20)	
DATE	DESCRIPTION		DATE	DESCRIPTION		ROAD NO.	COUNTY		FINANCIAL PROJECT ID
						SR 434	SEMINOLE		443838-1-52-01

ALEX W. HINKLE, P.E.
LICENSE NUMBER: 82354
PROTEAN DESIGN GROUP
100 EAST PINE STREET, SUITE 600
ORLANDO, FL 32801

T-22

THE OFFICIAL RECORD OF THIS SHEET IS THE ELECTRONIC FILE DIGITALLY SIGNED AND SEALED UNDER RULE 61G15-23.004, F.A.C.

[illegible]

4/17/2025 5:18:17 PM jparto\ja T:\Worksets\FDOT\4438381\5201\Signalization\PLDT5601.dgn

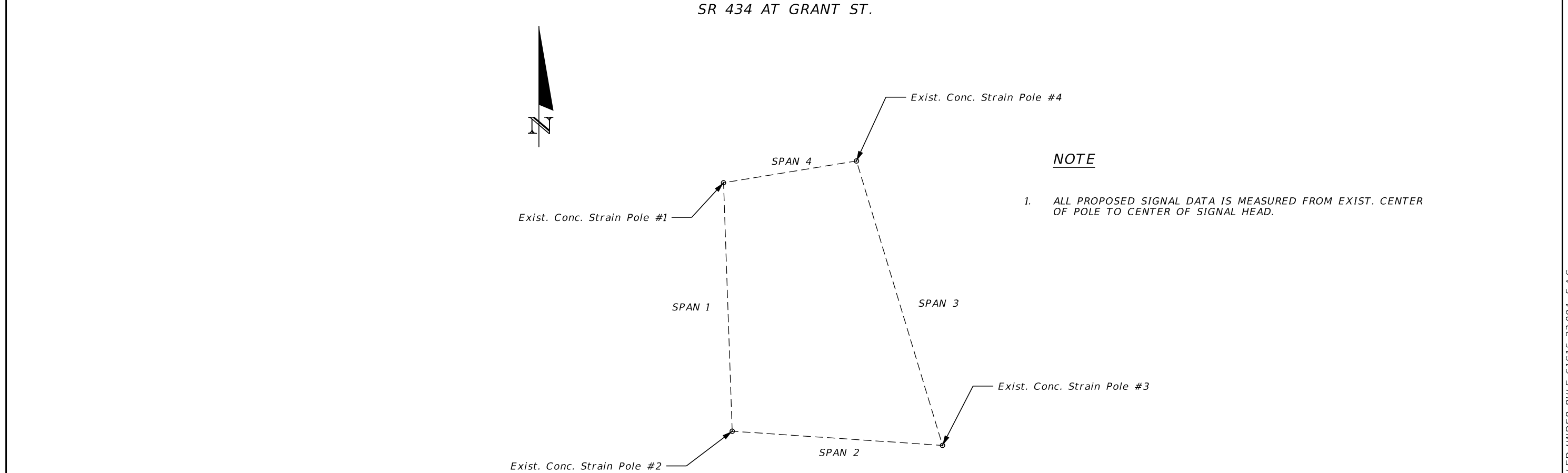

STRAIN POLE TABULATION										
POLE NO.	SHEET NO.	POLE LOCATION		CRIT. ROAD ELEV.	GROUND ELEV. AT POLE	SPAN	SPAN LENGTH	BACK-PLATES (Y/N)	CATENARY WIRE	MESSENGER WIRE
		STATION	OFFSET							
1	T-11	179+42.56	44.47' LT	Exist.	Exist.	1	98'	Y	TBD	TBD
2	T-11	179+45.96	53.95' RT		Exist.	2	83'			
3	T-11	180+26.60	61.48' RT		Exist.	3	118'			
4	T-11	179+96.70	52.35' LT		Exist.	4	53'			

POLE NO.	SHEET NO.	SPAN NO.	SIGNAL DATA DISTANCE FROM POLE/NUMBER OF SECTIONS					
			DIST.	SEC.	DIST.	SEC.	DIST.	SEC.
1 TO 2	T-11	1	20.7'	3	32.5'	3	44.3'	4
2 TO 3	T-11	2	17.0'	3*	27.0'	3*		
3 TO 4	T-11	3	37.9'	3	49.1'	3	59.9'	4
4 TO 1	T-11	4	16.3'	3*	28.4'	3*		

* DENOTES AN EXISTING HEAD TO REMAIN IN IT'S EXISTING LOCATION AND BE RETROFITTED WITH FLEXIBLE, REFLECTIVE BACKPLATES.

REVISIONS				ENGINEER OF RECORD	STATE OF FLORIDA DEPARTMENT OF TRANSPORTATION			STRAIN POLE TABULATION (1)
DATE	DESCRIPTION	DATE	DESCRIPTION	ALEX W. HINKLE, P.E. LICENSE NUMBER: 82354 PROTEAN DESIGN GROUP 100 EAST PINE STREET, SUITE 600 ORLANDO, FL 32801	ROAD NO.	COUNTY	FINANCIAL PROJECT ID	
					SR 434	SEMINOLE	443838-1-52-01	

ALEX W. HINKLE, P.E.
LICENSE NUMBER: 82354
PROTEAN DESIGN GROUP
100 EAST PINE STREET, SUITE 600
ORLANDO, FL 32801

THE OFFICIAL RECORD OF THIS SHEET IS THE ELECTRONIC FILE DIGITALLY SIGNED AND SEALED UNDER RULE 61G15-23.004, F.A.C.

4/17/2025 5:18:18 PM jparto\ja T:\Worksets\FDOT\443838\15201\Signalization\PLDTS601.dgn

SR 434 AT WAYMAN ST.



Exist. Conc. Strain Pole #2

SPAN 1

Exist. Conc. Strain Pole #1

NOTE

1. ALL PROPOSED SIGNAL DATA IS MEASURED FROM EXIST. CENTER OF POLE TO CENTER OF SIGNAL HEAD.

STRAIN POLE TABULATION

POLE NO.	SHEET NO.	POLE LOCATION		CRIT. ROAD ELEV.	GROUND ELEV. AT POLE	SPAN	SPAN LENGTH	BACK-PLATES (Y/N)	CATENARY WIRE	MESSENGER WIRE
		STATION	OFFSET							
1	T-15	192+98.61	43.72' RT	Exist.	Exist.	1	107'	Y	TBD	TBD
2	T-15	193+41.23	54.00' LT		Exist.					

POLE NO.	SHEET NO.	SPAN NO.	SIGNAL DATA DISTANCE FROM POLE/NUMBER OF SECTIONS																			
			DIST.	SEC.	DIST.	SEC.	DIST.	SEC.	DIST.	SEC.	DIST.	SEC.	DIST.	SEC.	DIST.	SEC.	DIST.	SEC.	DIST.	SEC.	DIST.	SEC.
1 TO 2	T-15	1	21.8'	3	34.6'	3	44.4'	3*	47.4'	4	47.9'	4	60.7'	3*	69.6'	3*	69.6'	3	73.5'	3	84.9'	3*

* DENOTES AN EXISTING HEAD TO REMAIN IN IT'S EXISTING LOCATION AND BE RETROFITTED WITH FLEXIBLE, REFLECTIVE BACKPLATES.

REVISIONS				ENGINEER OF RECORD	STATE OF FLORIDA DEPARTMENT OF TRANSPORTATION			STRAIN POLE TABULATION (2)	SHEET NO.
DATE	DESCRIPTION		DATE		ROAD NO.	COUNTY	FINANCIAL PROJECT ID		
					SR 434	SEMINOLE	443838-1-52-01		T-25

ALEX W. HINKLE, P.E.
LICENSE NUMBER: 82354
PROTEAN DESIGN GROUP
100 EAST PINE STREET, SUITE 600
ORLANDO, FL 32801